

RESOLUTION NO. 5660

A RESOLUTION ACCEPTING THE FOLLOWING RIGHT-OF-WAY DEDICATION:

Grantor

Gloria Rose Pruitt

Purpose

A right-of-way dedication for the construction of a new public sidewalk on the east side of North Albany Road.

NOW, THEREFORE, BE IT RESOLVED by the Albany City Council that it does hereby accept this right-of-way dedication deed.

DATED AND EFFECTIVE THIS 10TH DAY OF SEPTEMBER 2008.



Mayor

ATTEST:

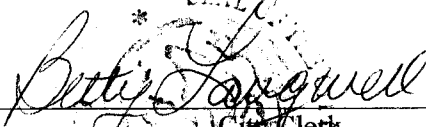

City Clerk

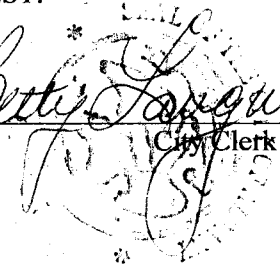

RIGHT-OF-WAY DEDICATION

KNOW ALL MEN BY THESE PRESENTS, that Gloria Rose Pruitt, hereinafter referred to as Grantor, hereby dedicate to the City of Albany, a Municipal Corporation, hereinafter called "City" for right-of-way purposes, portions of that real property situated in Benton County, Oregon, conveyed to Grantors by deed recorded in M-85812-87, Benton County deed records, and being more particularly described as follows:

A piece of land in Section 36 of Township 10 South in Range 4 West of Willamette Meridian, City of Albany, Benton County, Oregon as described in the attached Exhibit A, as shown on the attached map labeled Exhibit B and the attached vicinity map labeled Exhibit C.

The Grantor covenants that they are lawfully seized and possessed of the real property above described and that they have a good and lawful right to convey it or any part thereof and that they will forever warrant and defend the same against all persons who may lawfully claim the same.

The right-of-way dedicated herein is in consideration of \$5,400.00, receipt of which is acknowledged by the Grantor, and in further consideration of the public improvements to be placed upon said property and the benefits grantors may obtain therefrom.

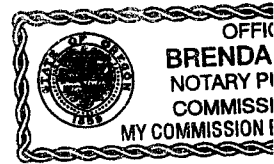

IN WITNESS WHEREOF, the Grantor has hereunto fixed their hand and seal the day and year written below.

GRANTOR:

Gloria Rose Pruitt
Gloria Rose Pruitt



STATE OF OREGON)
County of Linn) ss.
City of Albany)

The foregoing instrument was acknowledged before me this 24th day of July, 2008, by Gloria Rose Pruitt as her voluntary act and deed.

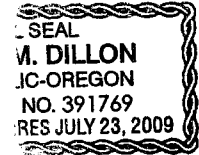

[Signature]
Notary Public for Oregon
My Commission Expires: July 23, 2009

CITY OF ALBANY:

STATE OF OREGON)
County of Linn) ss.
City of Albany)

I, Wes Hare as City Manager of the City of Albany, Oregon, pursuant to Resolution Number 51400, do hereby accept on behalf of the City of Albany, the above instrument pursuant to the terms thereof this 29 day of September 2008.

[Signature]
City Manager

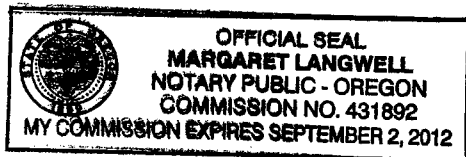

ATTEST:
[Signature]
City Clerk

Exhibit "A"
(Pruitt Dedication)

A tract of land lying in the Southeast 1/4 of Section 36, Township 10 South, Range 4 West, Willamette Meridian, City of Albany, Benton County, Oregon, said tract being a portion of that property described in M-85812-87, Benton County Deed Records, and more particularly described as follows:

Beginning at a point on the north line of that property described in M-85812-87, Benton County Deed Records, said point being 50.00 feet distant from the centerline of North Albany Road (County Road No. 14400); thence South 02°16'19" West 47.43 feet to a point that is 45.00 feet distant from said centerline; thence South 03°46'47" East, parallel with said centerline, a distance of 83.82 feet to the south line of said property; thence 11.76 feet on the arc of a 13.00 foot radius curve to the right (chord bears North 29°53'32" West 11.36 feet), to a point on the east right-of-way line of said road; thence on said line the following three courses: 1) North 03°46'47" West 73.10 feet, 2) South 52°27'07" West 12.03 feet, 3) North 03°46'47" West 46.75 feet to the northwest corner of said property; thence North 65°22'23" East, on the north line thereof, a distance of 21.40 feet to the Point of Beginning, all as shown on the map attached as "Exhibit "B" and made a part hereof.

This description was based on data from County Survey No. 10228 and County Survey No. 8721.

July 11, 2008
EXHIBIT "A"
PRUITT DEDICATION
(08-27-D) JSM:nm
File: nm\shared\legal\08-27-d Pruitt.doc

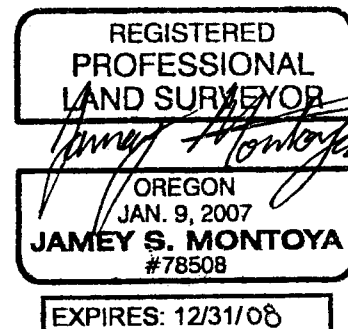

EXHIBIT "B"

R.O.W. DEDICATION

FOR

CITY OF ALBANY

LOCATED IN
 SE 1/4 SEC. 36, T. 10 S., R. 4 W., W.M.
 CITY OF ALBANY, BENTON COUNTY, OREGON
 JULY 10, 2008

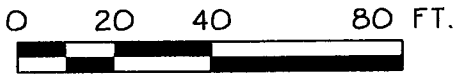
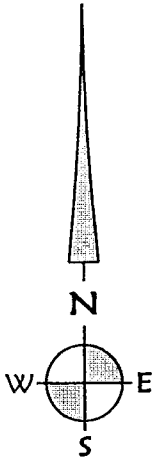

SCALE: 1" = 40'

SEE COUNTY SURVEY NO. 10228

WATSON
 (DOC. NO. 2007-420888)

REGISTERED
 PROFESSIONAL
 LAND SURVEYOR
Jamey Montoya
 OREGON
 JAN. 9, 2007
JAMEY S. MONTOYA
 #78508
 EXPIRES: 12/31/08

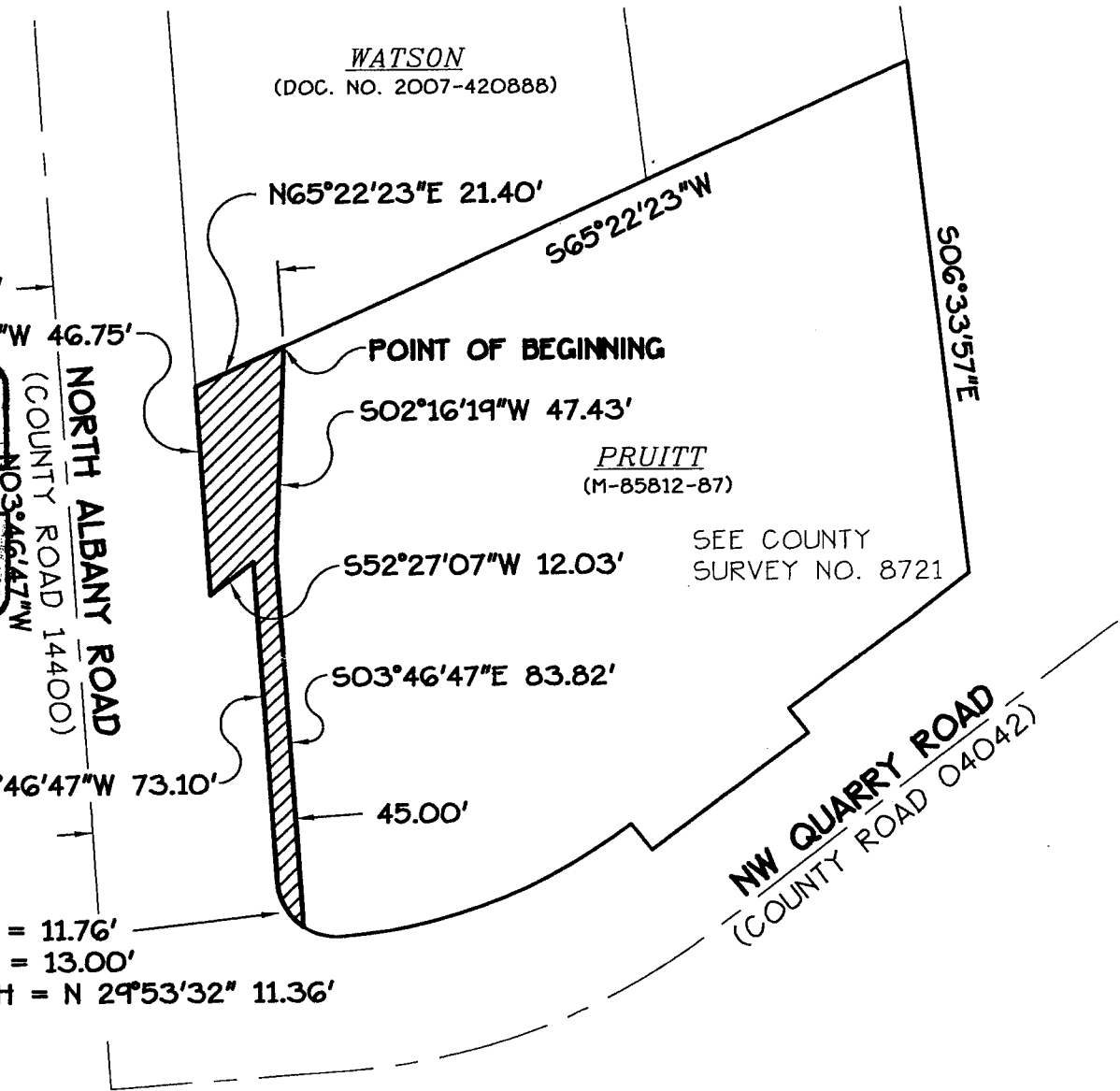

Date: 7/11/2008 Time: 8:34
 Scale: 1=1(P5)
 File: dwg\2008\08-27-D\0827d-exA.dwg (Jamey M)



K & D ENGINEERING, Inc.
 276 N.W. Hickory Street P.O. Box
 Albany, Oregon 97321
 (541) 928-2583

EXHIBIT C

10S04W36DA03700

A right-of-way dedication for
the construction of a public
sidewalk.



Geographic Information Services

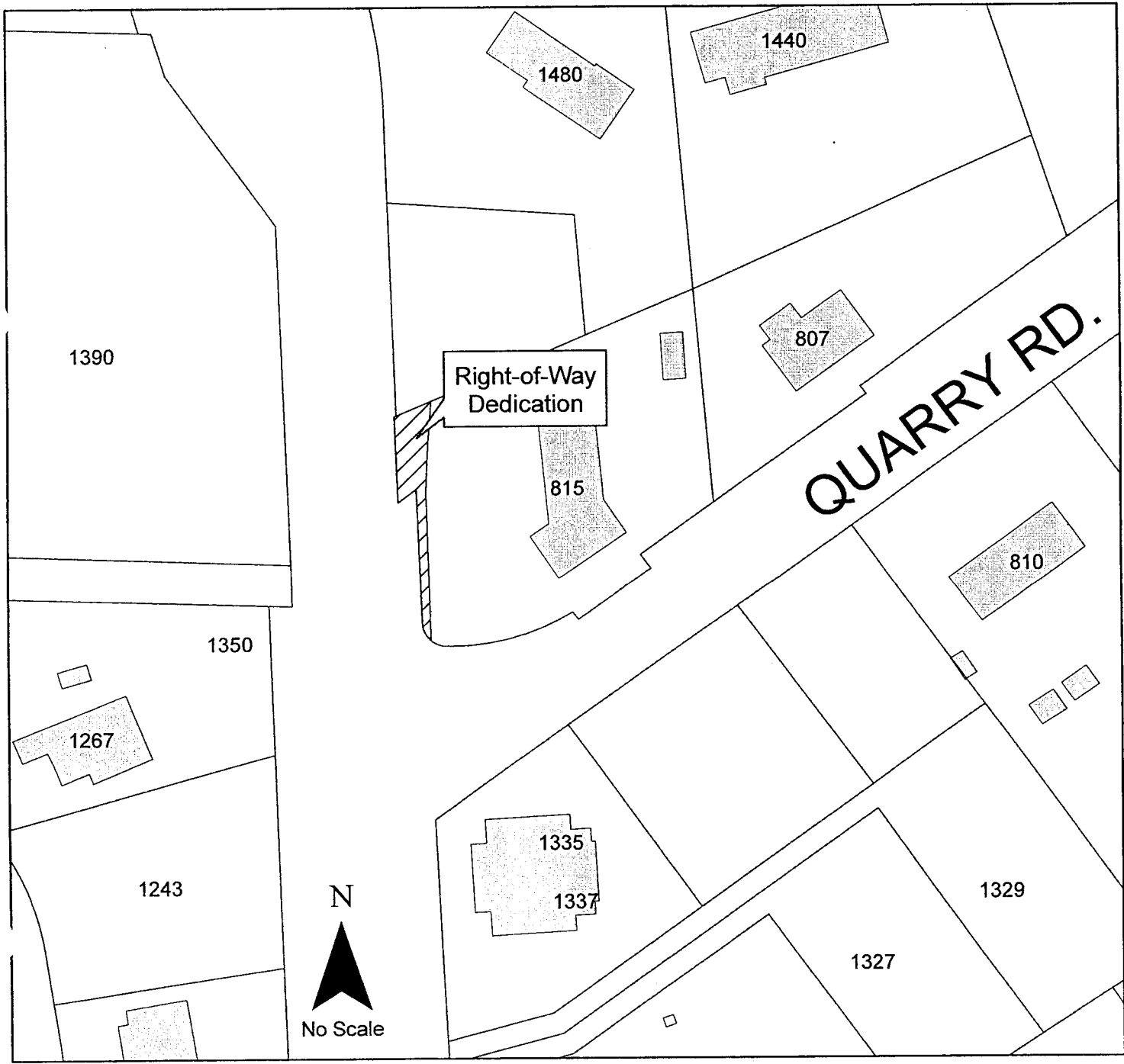
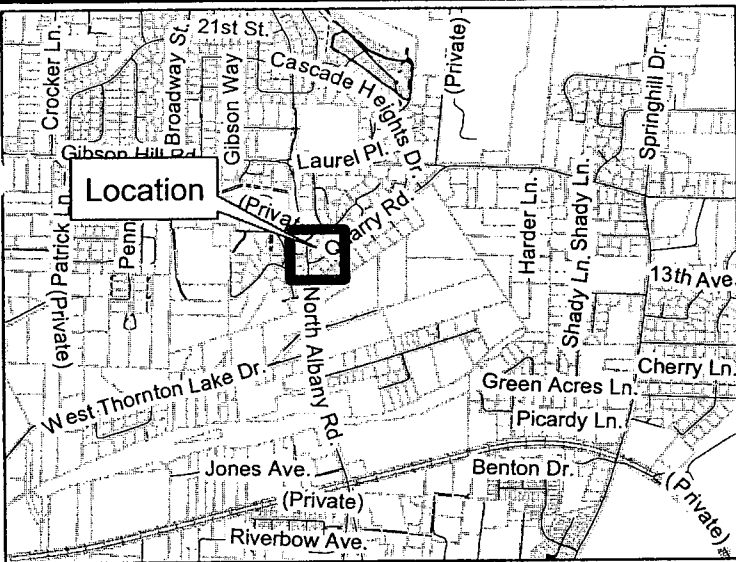



RECORDING COVER SHEET (Please Print or Type)

This cover sheet was prepared by the person presenting the instrument for recording. The information on this sheet is a reflection of the attached instrument and was added for the purpose of meeting first page recording requirements in the State of Oregon, ORS 205.234, and does NOT affect the instrument.

I, James V. Morales, County Clerk for Benton County, Oregon, certify that the instrument identified herein was recorded in the Clerk records.

James V. Morales - County Clerk



AFTER RECORDING RETURN TO:

City of Albany Recorder _____

PO Box 490 _____

Albany, OR 97321 _____

All Tax Statements Should Be Sent To:

Government Agency - Exempt _____

1. Name/Title of Transaction - by ORS 205.234 (a)

RIGHT-OF-WAY DEDICATION

2. Grantor/Direct Party - required by ORS 205.125(1)(b) and ORS 205.160

Gloria Rose Pruitt _____

3. Grantee/Indirect Party - required by ORS 205.125(1)(a) and ORS 205.160

City of Albany _____

4. True and Actual Consideration (if there is one), ORS 93.030

\$5,400.00 _____

Resolution No. 5660

Recorded Document Recorder File No. 5198