

RESOLUTION NO. 4531

A RESOLUTION ACCEPTING THE FOLLOWING DEDICATION DEED:

Grantor

Joseph F. Chido
Mary E. Chido

Purpose

A permanent Dedication Deed described in attached EXHIBIT A and as shown in attached EXHIBIT B.

NOW, THEREFORE, BE IT RESOLVED by the Albany City Council that it does hereby accept this easement.

DATED THIS 10TH DAY OF OCTOBER, 2001.



Mayor

ATTEST:



City Clerk

DEDICATION DEED
N-014

Joseph + Mary

KNOW ALL MEN BY THESE PRESENTS, that ~~the~~ Chido's, hereinafter referred to as the Grantor, does dedicate to the City of Albany for street and utility right-of-way purposes situated in Linn County, State of Oregon, described as follows:

A tract of land as described in the attached description and as shown on Attached EXHIBIT A.

and covenants that the Grantor is the owner of the above described real property free of all encumbrances save and except reservations in patents and easements or record, and will warrant and defend the same against all persons who may lawfully claim the same.

The deed granted herein is in consideration of \$1.00, receipt of which is acknowledged by the Grantor, and in further consideration of the public improvements to be placed upon said property and the benefits grantors may obtain there from. Nothing herein shall reduce or limit grantors obligation to pay any costs or assessments, which may result from the improvements.

IN WITNESS WHEREOF, the Grantors have hereunto affixed their signatures this 23rd day of May, 2001.

GRANTOR:

Joseph F. Chido
JOSEPH F. CHIDO

STATE OF OREGON)
County of Linn)
City of Albany)

The foregoing instrument was acknowledged Before me this 23rd-day of May, 2001 by his voluntary act and deed.

Matthew A. Ruettgers
Notary Public for Oregon
My Commission Expires: 2-28-05

GRANTOR:

Mary E. Chido
MARY E. CHIDO

STATE OF OREGON)
STATE OF OREGON)
City of Albany)

The foregoing instrument was acknowledged Before me this 23rd-day of May, 2001 by his voluntary act and deed.

Matthew A. Ruettgers
Notary Public for Oregon
My Commission Expires: 2-28-05

Return to: City of Albany - Recorder
P.O. Box 490, Albany, OR 97321

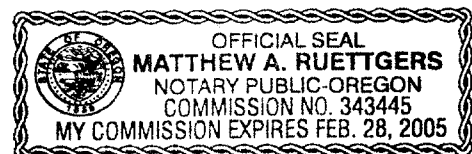
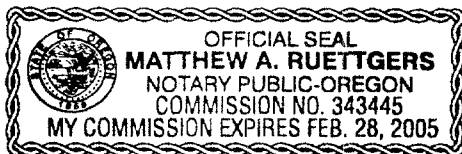

N-014

CITY OF ALBANY

STATE OF OREGON)
County of Linn)
City of Albany)

I, Steve Bryant as City Manager of the
City of Albany, Oregon, pursuant to Resolution
Number 4531, do hereby accept on
Behalf of the City of Albany, the above
Instrument pursuant to the terms thereof this
11 Day of October,
2001.

Steve Bryant
City Manager

ATTEST:

Margaret Langwell
City Recorder
J Clerk

DEDICATION DEED TO THE CITY OF ALBANY

N-014

A portion of that certain tract of land described in Book 345 Page 167 of Linn County Deed of Records, described as follows:

Beginning at the southeast corner of said tract, thence along its East line a distance of 5 feet; thence parallel to the Northerly right-of-way of 34th Avenue a distance of 12 feet to a point; thence parallel to said East line a distance of 5 feet to a point lying on said Northerly right-of-way; thence along said Northerly right-of-way a distance of 12 feet to the point of beginning, All lying in the SE ¼ of Section 17, Township 11 South, Range 03 West, Willamette Meridian, Linn County, Oregon and containing 60 square feet, more or less.

For reference purposes, this tract of land can be seen on tax assessors map 113W17D tax lot 503, and on the attached exhibit 'A'.

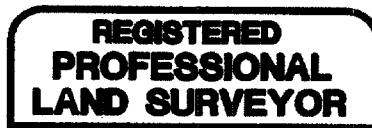

Leonard L. Smith



RENEWAL 6/30/2002

EXHIBIT 'A'
N-014

STREET ADDRESS 2329
TAX MAP 113W17D
TAX LOT 503



SCALE: NTS

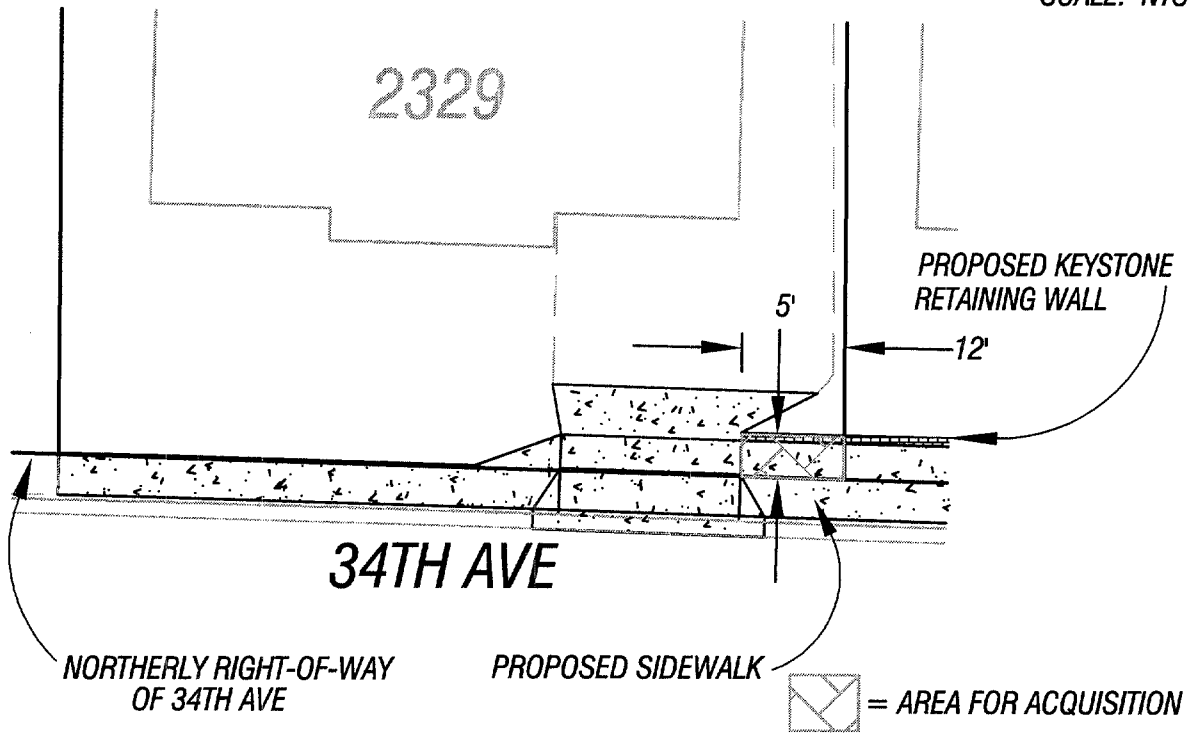

**REGISTERED
PROFESSIONAL
LAND SURVEYOR**

Leonard L. Smith

**OREGON
SEPTEMBER 23, 1977
LEONARD L. SMITH
1329**

RENEWAL 6/30/2002

**PacWest
Engineering**

1530 NINTH AVE. SE
ALBANY, OR. 97321

TEL 1-888-926-7634
FAX 541-926-7539

Client:
CITY OF ALBANY

Drawn:
J. BLAINE

Calc'd:
J. BLAINE

Field:
D. BECKER

Checked:
L. SMITH

Project:
99-051

Drawing No.:
ROWTAKES/BASE

Date:
02-22-01

Scale:
NTS

Page Of
2 2

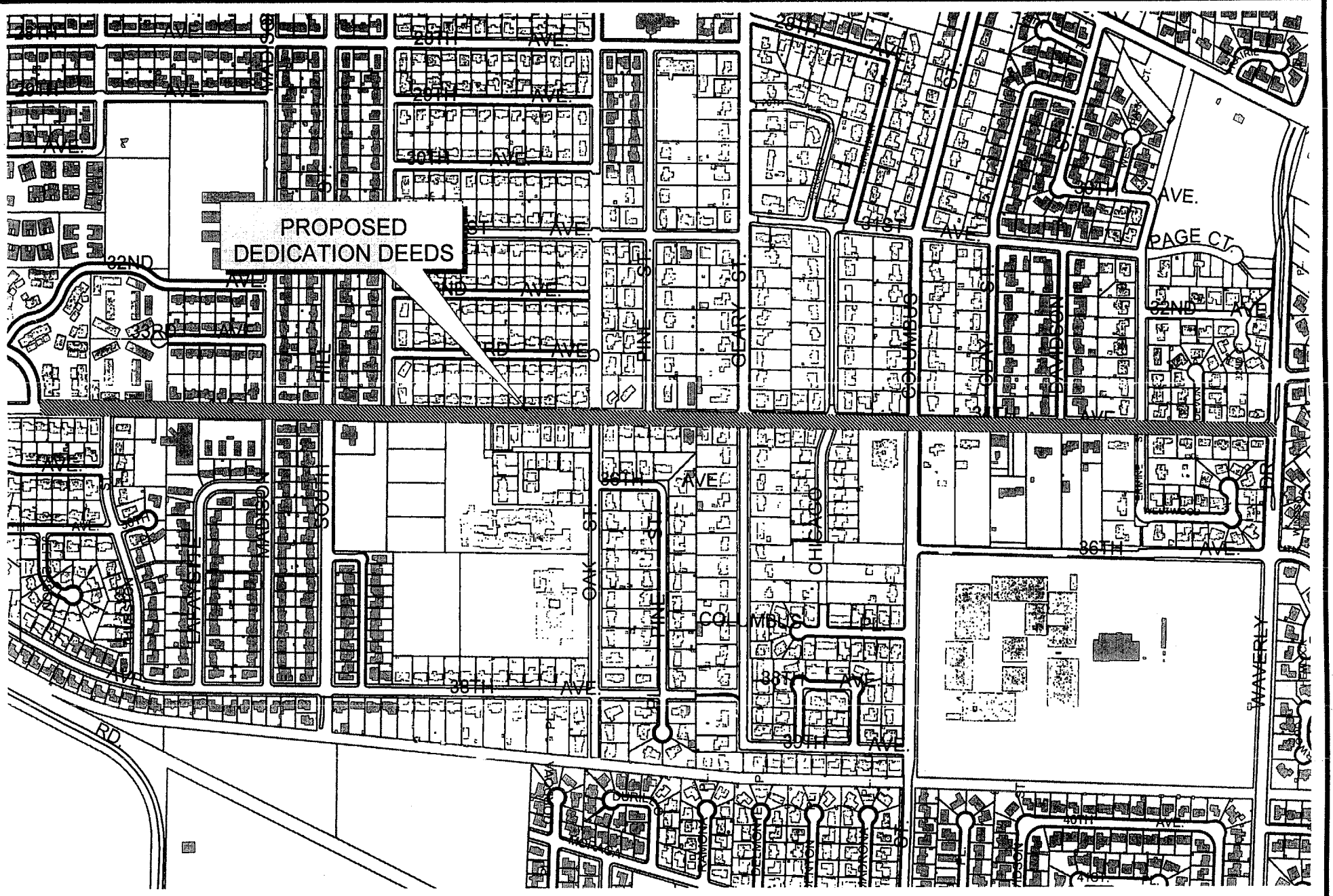

VOL. 1226 PAGE 595 1/2

VICINITY MAP

ST-01-01 34th Ave, Rehabilitation, Phase II



Dedication Deeds

Engineering - Angie

Mark Shepard

Sep 28, 2001

angies g:\engineer\gis\vicinity map.apr

600 0 600 Feet

The City of Albany's Infrastructure records, drawings, and other documents have been gathered over many decades, using differing standards for quality control, documentation, and verification. All the information provided represents current information in a readily available format. While the information provided is generally believed to be accurate, occasionally this information proves to be incorrect, and thus its accuracy is not warranted. Prior to making any property purchases or other investments based in full or in part upon the information provided, it is specifically advised that you independently field verify the information contained within our records.



STATE OF OREGON
County of Linn

I hereby certify that the attached
was received and duly recorded
by me in Linn County records.

STEVE DRUCKENMILLER
Linn County Clerk

By SD, Deputy

M
B
S
O
ALL

1226

MF
PAGE 592

2001 OCT 22 P 1:57

46

Resolution No. 4531

Recorded Document Recorder File No. 3910