

A RESOLUTION AUTHORIZING THE CITY OF ALBANY PARKS AND RECREATION DEPARTMENT TO APPLY FOR A FEDERAL LAND AND WATER CONSERVATION FUND GRANT FROM THE OREGON PARKS AND RECREATION DEPARTMENT FOR THE REPLACEMENT OF ELEANOR HACKLEMAN PARK PLAYGROUND EQUIPMENT AND DELEGATING AUTHORITY TO THE CITY MANAGER TO SIGN THE APPLICATION.

WHEREAS, the Oregon Parks and Recreation Department is accepting applications for the Federal Land and Water Conservation Fund Grant Program; and

WHEREAS, the City of Albany Parks and Recreation Department desires to participate in this grant program to the greatest extent possible as a means of providing needed park and recreation acquisitions, improvements and enhancements; and

WHEREAS, the City of Albany Parks & Recreation Commission, City Council, and staff have identified improvements at Eleanor Hackleman Park Playground as a high priority need in the City of Albany; and

WHEREAS, the project will install new playground equipment at Eleanor Hackleman Park, a 2.16-acre neighborhood park. Existing equipment does not meet Americans with Disabilities Act (ADA) accessibility or American Society for Testing and Materials (ASTM) safety standards, and it is inadequate for the increasing demands. This project includes the installation of two age-appropriate structures, one for children aged 2-5 years and another for children aged 5-12 years.

WHEREAS, the applicant hereby certifies that the matching share for this application is readily available at this time in the Parks and Recreation Maintenance Fund and committed by the Kiwanis Club; and

IT IS HEREBY ORDERED that the City of Albany Parks and Recreation Department be authorized to apply for a Local Government Grant from the Oregon Parks and Recreation Department for the Eleanor Hackleman Park Playground as specified above.

DATED THIS 11th DAY OF JULY 2001.

Council President

ATTEST:



City Recorder

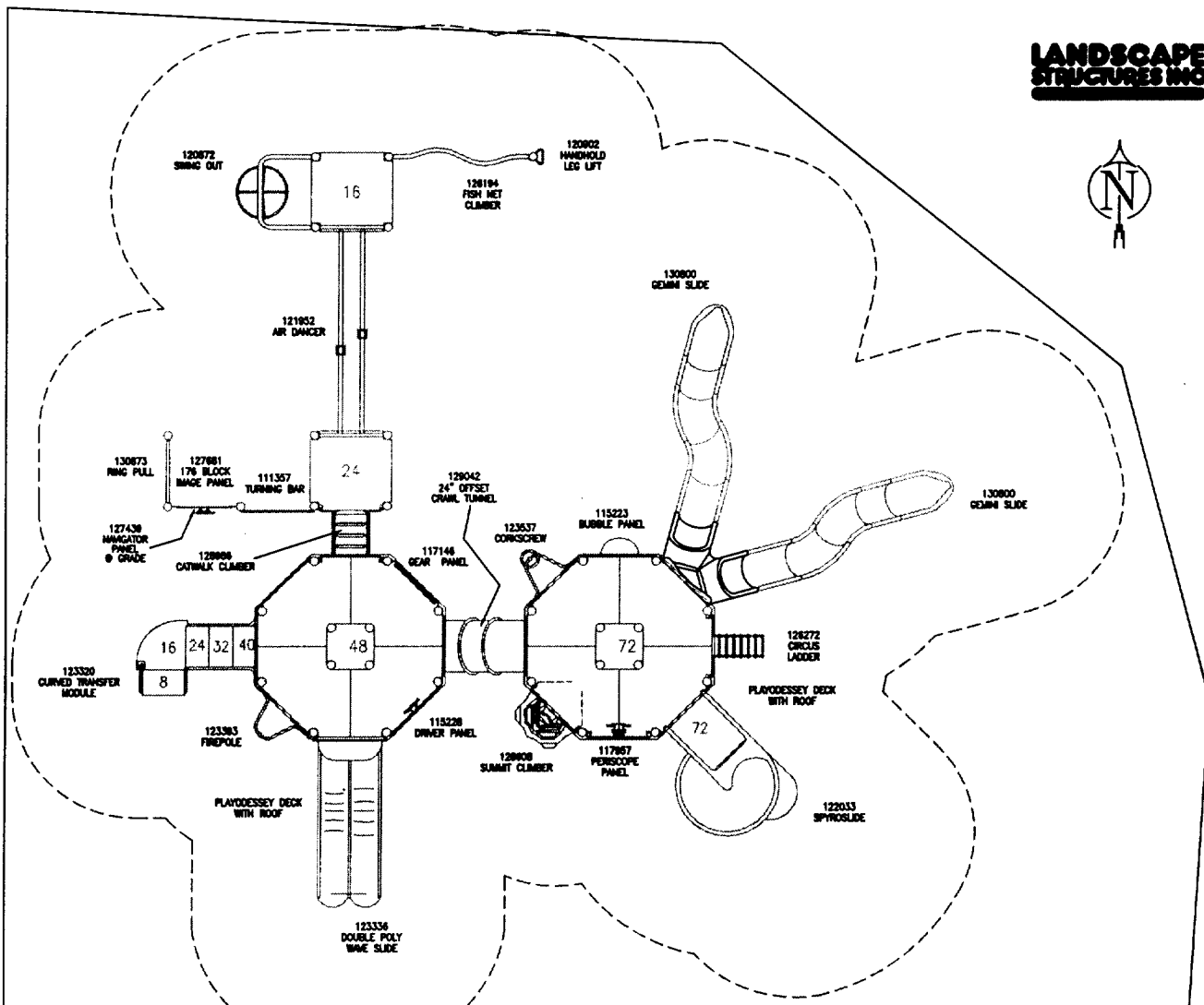

TOTAL ELEVATED PLAY COMPONENTS	16		
TOTAL ELEVATED COMPONENTS ACCESSIBLE BY RAMP	0	REQUIRED	0
TOTAL ELEVATED COMPONENTS ACCESSIBLE BY TRANSFER	14	REQUIRED	8
TOTAL ACCESSIBLE GROUND LEVEL COMPONENTS SHOWN	5	REQUIRED	5
TOTAL DIFFERENT TYPES OF GROUND LEVEL COMPONENTS	5	REQUIRED	3

115106 TALK TUBE
111362 TALK TUBE 40' TUBING KIT

120952 TUBING SLD W/2 VIEW TUBES

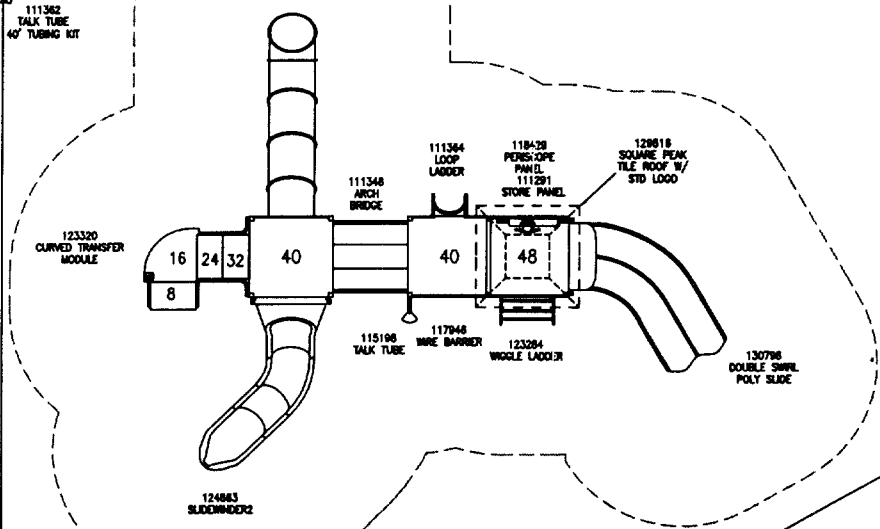

Eleanor Park
Albany, OR
LANDSCAPE STRUCTURES
PLAYBOOSTER AND PLAYSHAPER
6/10/01 DRAWN BY: JD
STRUCTURE DIMENSIONS:
ACTUAL SIZE:
AREA REQUIRED:

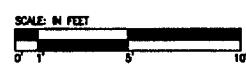

TOTAL ELEVATED PLAY COMPONENTS	7		
TOTAL ELEVATED COMPONENTS ACCESSIBLE BY RAMP	0	REQUIRED	0
TOTAL ELEVATED COMPONENTS ACCESSIBLE BY TRANSFER	7	REQUIRED	4
TOTAL ACCESSIBLE GROUND LEVEL COMPONENTS SHOWN	2	REQUIRED	2
TOTAL DIFFERENT TYPES OF GROUND LEVEL COMPONENTS	2	REQUIRED	2

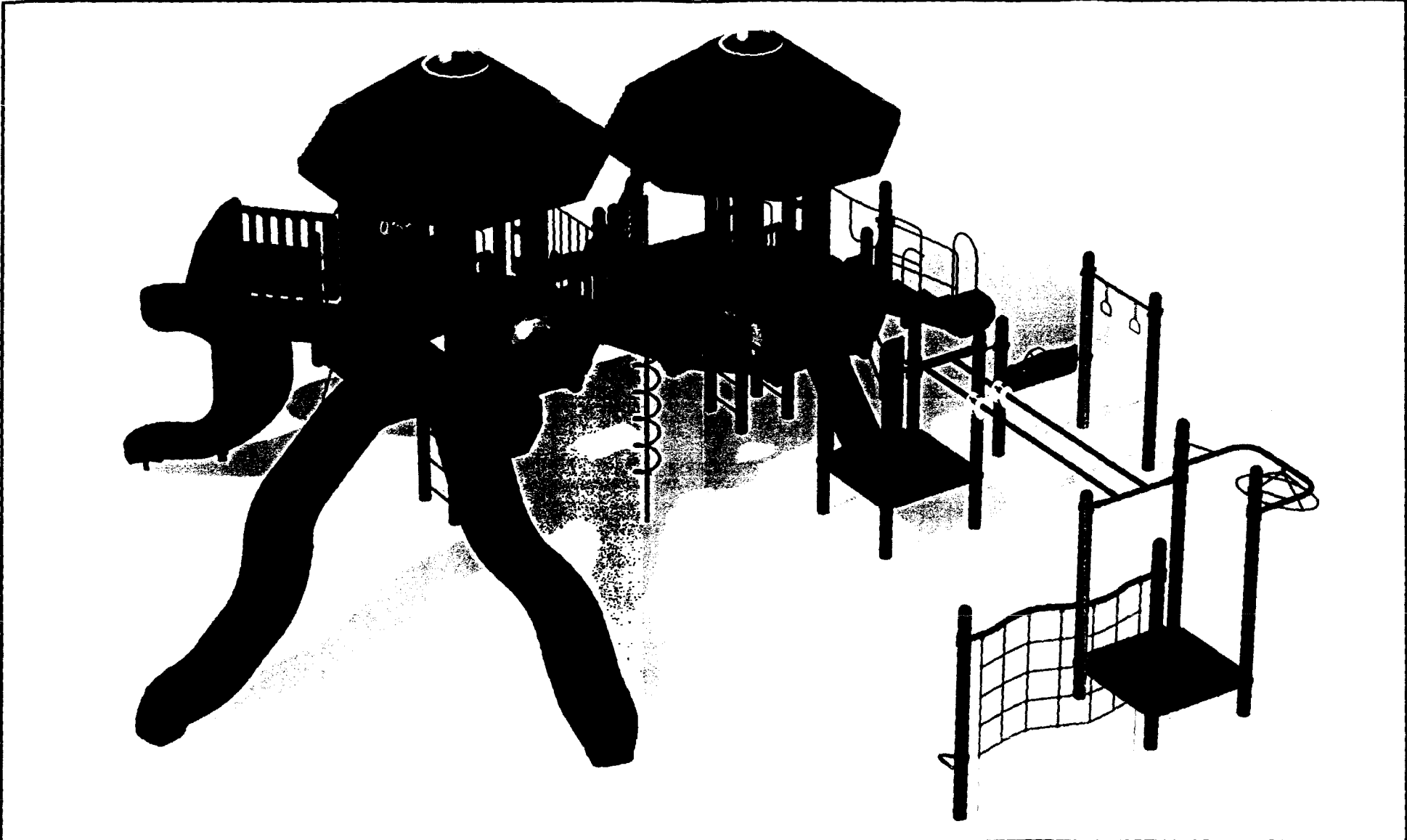

**LANDSCAPE
STRUCTURES INC**

Anything else is cutting corners.



**ELEANOR PARK
ALBANY, OR**

06/13/2001

Brock S.

1872713A



**EDUCATION
RESOURCE**
THE LEARNING CONNECTION

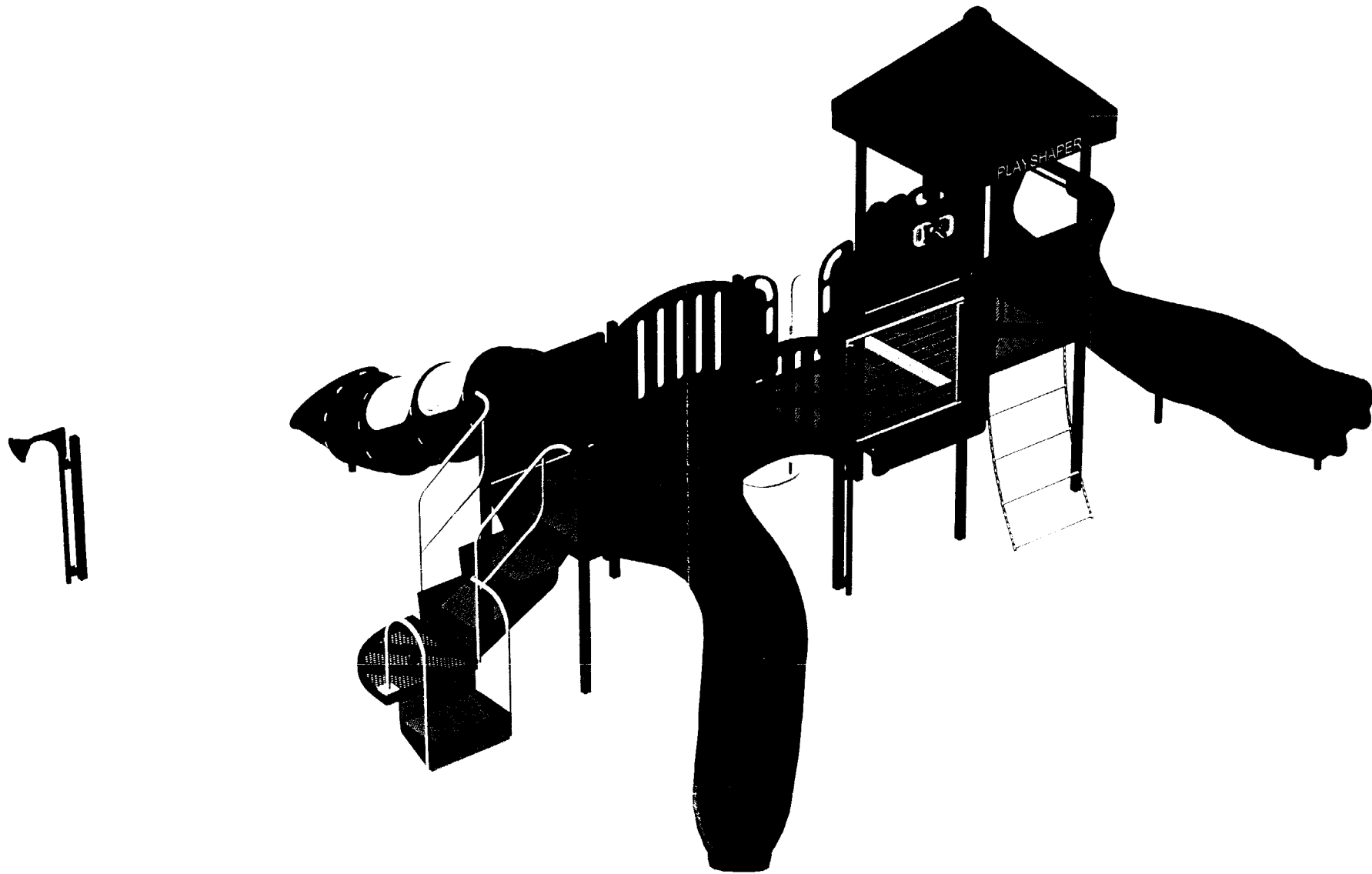

**LANDSCAPE
STRUCTURES INC**

Anything else is cutting corners.



**ELEANOR PARK
ALBANY, OR**

06/13/2001

Brock S.

1872713E

