

RESOLUTION NO. 2189

ADOPTION OF ENGINEER'S REPORTS, AUTHORIZATION TO SECURE EASEMENTS, TO OBTAIN BIDS, TO INCREASE APPROPRIATIONS, AND TO ISSUE WARRANTS FOR CONSTRUCTION OF SD-80-1, WAVERLY STORM DRAIN EXTENSION.

BE IT RESOLVED that the reports of the City Engineer filed with the City Recorder on the 23rd day of July, 1980, concerning SD-80-1, Waverly Storm Drain Extension, be and the same are hereby adopted.

BE IT FURTHER RESOLVED that the Council authorize the Mayor and City Recorder to sign agreements on behalf of the City of Albany for the purpose of obtaining easements to construct the said improvements, direct the City Manager to obtain bids for the construction of said projects as required by law, and authorize the Mayor and City Recorder to make, issue, and negotiate General Obligation Improvement Warrants for the performance of said improvements, bearing interest not to exceed 8% per annum, and constituting general obligations of the City of Albany. The terms of conditions of such warrants shall be as provided by ORS 287.502 to 287.510.

BE IT FURTHER RESOLVED that funds budgeted within the Improvement Fund be appropriated as follows:

<u>RESOURCE</u>	<u>FROM</u>	<u>TO</u>
<u>Improvement Fund</u>		
Sewer Construction Fund (26-985-86001)	\$57,970.	
<u>REQUIREMENT</u>		
<u>Improvement Fund</u>		
Project #SD-80-1 (26-985-88070)		\$57,970.

DATED this 23rd day of July, 1980.

Richard S. Olsen
Mayor

ATTEST:

[Signature]
City Recorder

Tom M

INTERDEPARTMENTAL MEMORANDUM
Engineering Department

SUBJECT: Engineer's Report for SD-80-1, Waverly Storm Drain Extension
TO: Mayor and Members of the City Council
VIA: City Manager
FROM: Ben Shaw, Civil Engineer I
DATE: July 9, 1980 for July 23rd meeting

Project Description

This project is intended to provide a storm drainage trunk line to a portion of Land West Development's 266 acre annexation.

The project shall consist of constructing 500 L.F. of 60" storm drain pipe from Waverly Drive at a point 200 feet south of 21st Avenue to a point 500 feet east. Also, 3950 L.F. of intercepting ditches will be constructed.

No public hearing is necessary as the affected property owners have signed a petition and waiver of remonstrance for this project.

Project Cost Data:

Estimated Construction Cost	\$52,700.00
10% Contingencies	5,270.00
Sub-total	<u>57,970.00</u>
13% ELA	7,536.10
Warrant Interest	<u>1,150.00</u>
Total Assessable Cost	\$66,656.10

Method of Assessment:

It is proposed that the benefitting properties be assessed on a per acre basis.

Assessment Data:

Please refer to attached sheet.

Respectfully submitted,

Benjamin Shaw

Benjamin Shaw
Civil Engineer I

Approved by:

Jim Rankin
Jim Rankin
City Engineer Pro Tem

aph

PROPERTY AND ASSESSMENT DATA

SD-80-1 Waverly Storm Drain Extension

Office of City Engineer

NO.	OWNER/ADDRESS	TAX LOT AND DESCRIPTION	ASSESS. ACRES	TOTAL ASSESSMENT
1.	Land West Development 3828 Linn Avenue N.E. Albany, OR 97321	11-3W-16 T.L. 800	100 Acres	\$60,596.45
2.	Greater Albany Public Schools 2310 Elm S.W. Albany, OR 97321	11-3W-16 T.L. 801	10 Acres	\$ 6,059.65
				<u>\$66,656.10</u>

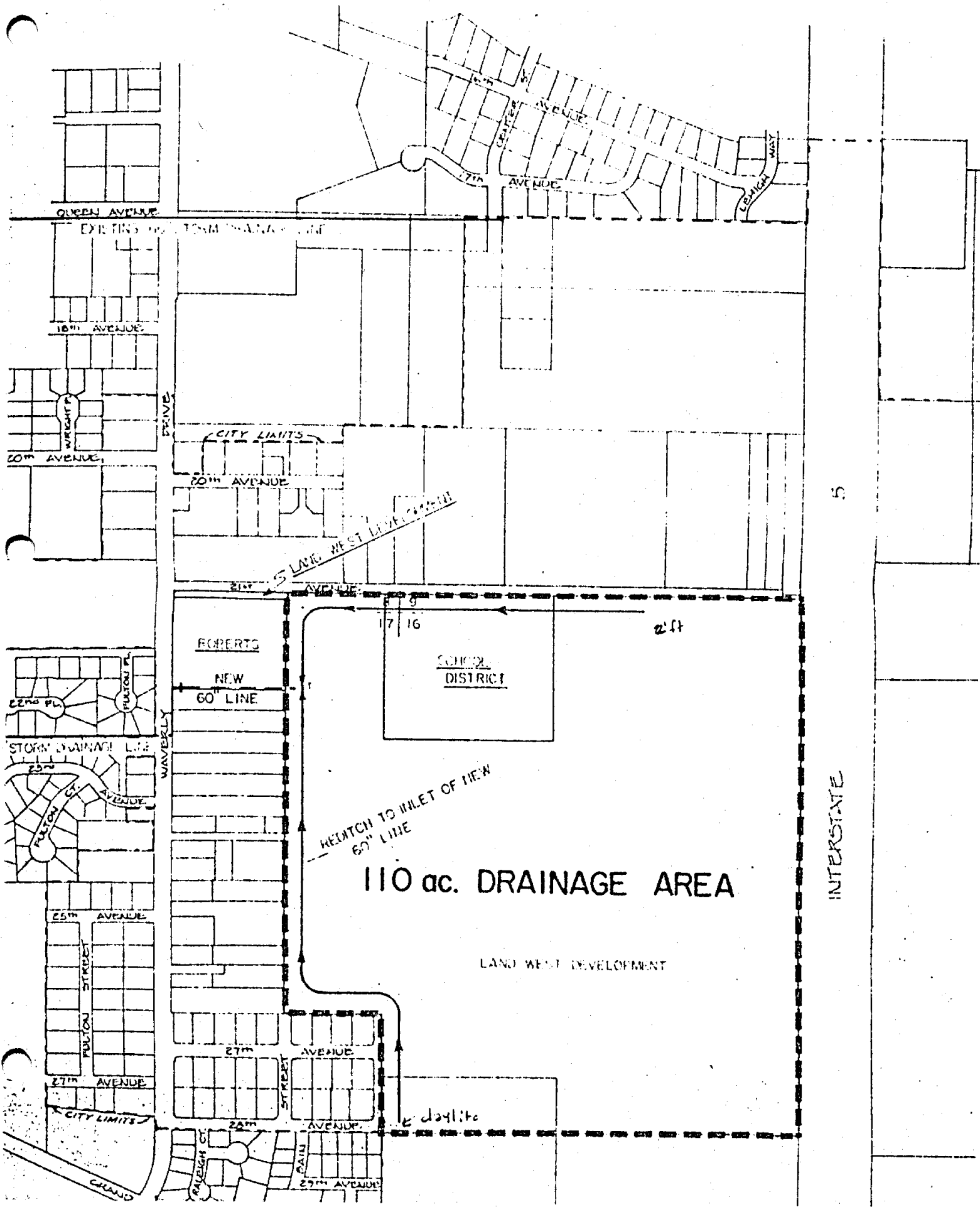

ROBERTS

NEW

60" LINE

SCHOOL DISTRICT

HEDITCH TO INLET OF NEW 60" LINE

110 ac. DRAINAGE AREA

LAND WEST DEVELOPMENT

daylite

5

INTERSTATE