

APPENDIX A

Oregon Department of Transportation



APPLICATION AND PERMIT TO OCCUPY OR PERFORM OPERATIONS UPON A STATE HIGHWAY

See Oregon Administrative Rule, Chapter 734, Division 55

PERMIT NUMBER

04M55208

CLASS :

KEY#

| | | | | | |
|--|---|---|---|-----------------------------------|----------------------------------|
| GENERAL LOCATION | | | PURPOSE OF APPLICATION (TO CONSTRUCT/OPERATE/MAINTAIN) | | |
| HIGHWAY NAME AND ROUTE NUMBER I-5 / 1 / Pacific | | | <input type="checkbox"/> POLE LINE | TYPE | MIN. VERT. CLEARANCE |
| HIGHWAY NUMBER 1 / 1MV | COUNTY Linn | | <input type="checkbox"/> BURIED CABLE | TYPE | |
| BETWEEN OR NEAR LANDMARKS Between Exit 233 and 234 | | | <input checked="" type="checkbox"/> PIPE LINE | TYPE Sanitary sewer | |
| HWY. REFERENCE MAP GIS | DESIGNATED FREEWAY <input checked="" type="checkbox"/> YES <input type="checkbox"/> NO | IN U.S. FOREST <input type="checkbox"/> YES <input checked="" type="checkbox"/> NO | <input type="checkbox"/> NON-COMMERCIAL SIGN AS DESCRIBED BELOW | | |
| APPLICANT NAME AND ADDRESS CITY OF ALBANY ATTN: CHRIS CERKLEWSKI PO BOX 490 ALBANY, OR 97321 | | | <input type="checkbox"/> MISCELLANEOUS OPERATIONS AND/OR FACILITIES AS DESCRIBED BELOW | | |
| | | | FOR ODOT USE ONLY | | |
| | | | BOND REQUIRED <input checked="" type="checkbox"/> YES <input type="checkbox"/> NO | REFERENCE: OAR 734-055-0035(2) | AMOUNT OF BOND \$20,000 |
| | | | INSURANCE REQUIRED <input checked="" type="checkbox"/> YES <input type="checkbox"/> NO | REFERENCE: OAR 734-055-0035(1) | SPECIFIED COMP. DATE 1-1-2025 |

DETAIL LOCATION OF FACILITY (For more space attach additional sheets)

Bond # CK 313004

| MILE POINT | TO | MILE POINT | ENGINEERS STATION TO | ENGINEERS STATION | SIDE OF HWY OR ANGLE OF CROSSING | DISTANCE FROM | | BURIED CABLE OR PIPE | | SPAN LENGTH |
|------------|----|------------|----------------------|-------------------|----------------------------------|----------------|----------|-------------------------|---------------------------------|-------------|
| | | | | | | CENTER OF PVMT | R/W LINE | DEPTH/VERT. | SIZE AND KIND | |
| 233.73 | | 233.73 | F1081+05 | | 90 degrees | Varies | Varies | 16' to 22' | 24" PVC inside 36" steel casing | 304' |
| 233.68 | | 233.73 | F1084+75 | | West Side | 14' to 24' | 14' | 6.8' to 8.9' 10' min | 8" PVC | 277' |

DESCRIPTION OF DESIRED USE

- New 24" PVC sewer across Interstate 5
- Remove existing 8" sewer and replace in-place with new 8" sewer along the west side of Airport Road south of North Shore Drive.

SPECIAL PROVISIONS (FOR ODOT USE ONLY)

TRAFFIC CONTROL REQUIRED

YES [OAR 734-055-0025(6)] NO

OPEN CUTTING OF PAVED OR SURFACED AREAS ALLOWED

YES [OAR 734-055-0100(2)] NO [OAR 734-055-0100(1)]

AT LEAST 48 HOURS BEFORE BEGINNING WORK, THE APPLICANT OR HIS CONTRACTOR SHALL NOTIFY THE DISTRICT REPRESENTATIVE Any Permit Staff AT PHONE NO.: 541-757-4211 OR EMAIL OR FAX THIS PAGE TO THE DISTRICT OFFICE AT: James.C.Firestone@ODOT.oregon.gov. SPECIFY TIME AND DATE WORK IS TO OCCUR.

A COPY OF THIS PERMIT AND ALL ATTACHMENTS SHALL BE AVAILABLE AT THE WORK AREA DURING CONSTRUCTION.

ATTENTION: Oregon Law requires you to follow rules adopted by the Oregon Utility Notification Center. Those rules are set forth in OAR 952-001-0001 through OAR 952-001-0090. You may obtain copies of the rules by calling the center at (503) 232-1987.

CALL BEFORE YOU DIG 1-800-332-2344

COMMENTS (FOR ODOT USE ONLY)

This permit requires a final inspection. Please call: (541) 757-4211 to schedule.

Permit and permission to conduct work within the ODOT right of way. See attached provisions, pages 2-8.

IF THE PROPOSED APPLICATION WILL AFFECT THE LOCAL GOVERNMENT, THE APPLICANT SHALL ACQUIRE THE LOCAL GOVERNMENT OFFICIAL'S SIGNATURE BEFORE ACQUIRING THE DISTRICT MANAGER'S SIGNATURE.

| | | |
|--|-------------------------------------|-----------------------------------|
| LOCAL GOVERNMENT OFFICIAL SIGNATURE <input checked="" type="checkbox"/> <u>Christopher J. Allen</u> | TITLE <u>Civil Engineer III</u> | DATE <u>12/28/23</u> |
| APPLICANT SIGNATURE <input checked="" type="checkbox"/> <u>Christopher J. Allen</u> | APPLICATION DATE <u>12/28/23</u> | TITLE <u>Civil Engineer II</u> |
| DISTRICT MANAGER OR REPRESENTATIVE <input checked="" type="checkbox"/> <u>Kenneth Wouks</u> | | TELEPHONE NO. <u>541977646</u> |
| When this application is approved by the Department, the applicant is subject to, accepts and approves the terms and provisions contained and attached: and the terms of Oregon Administrative Rules, Chapter 734, Division 55, which is by this reference made a part of this permit. | | APPROVAL DATE <u>3/26/24</u> |

Prepared By J

Reviewed By Case

Case

Plbl

√GENERAL PROVISIONS FOR POLELINE, 0 4 M 5 5 2 0 8
PIPELINE, BURIED CABLE PERMITS AND MISCELLANEOUS PERMITS

(Rev) May 2003

| | | | |
|---------------------------------|-------------------------------|--------------------------|--|
| APPLICANT: See page 1 | HIGHWAY: See page 1 | MP: See page 1 | |
|---------------------------------|-------------------------------|--------------------------|--|

All checked (√) provisions apply.

WORKSITE

- √1. Permittee must call for utility locates before digging ("Call Before You Dig") 1-800-332-2344 per Oregon Administrative Rules (Chapter 952, Division 1). You may be held liable for damages. Pre-marking of excavation areas is required.
- √2. Permittee shall have a copy of this permit and all attachments at the work site. They shall be available to the District Manager or representative at their request.
3. Permittee shall acknowledge, in writing, receipt and review of Oregon Administrative Rules (Chapter 734, Division 55) governing miscellaneous facilities and operations on the highway right of way as the governing provisions of this permit or agreement. Copies of this rule may be obtained from any district maintenance office.
- √4. Permittee shall review the Oregon Administrative Rules (Chapter 734 Division 55) governing miscellaneous facilities and operations on the highway right of way as the governing provisions of this permit or agreement. Web Site: http://arcweb.sos.state.or.us/rules/OARS_700/OAR_734/734_055.html.
5. Access control fence must be maintained during construction and restored to its original or better condition after construction is complete.
- √6. The Permittee shall not use state highway right of way to display advertising signs or merchandise of any kind.
- √7. The stopping and parking of vehicles upon state highway right of way for the maintenance of adjoining property or in furtherance of any business transaction or commercial establishment is strictly prohibited.
- √8. All grass and small brush within the work area shall be rotary or flail mowed to ground level prior to the beginning of work to facilitate clean up. Disturbed areas shall be reseeded with grass native to the area in an appropriate seeding time.
- √9. The spreading of mud or debris upon any state highway is strictly prohibited and this violation shall be cause for immediate cancellation of the permit. Clean up shall be at the applicant's expense. The highway shall be cleaned of all dirt and debris at the end of each workday, or more frequently if so determined by the District Manager or representative.
- √10. Permittee shall replace any landscape vegetation or fences that are destroyed. Any damage that is not fully recovered within 30 days (weather permitting) shall be replaced by ODOT at the expense of the Permittee. A "plant establishment" shall be understood to be part of the planting work to assure satisfactory growth of planted materials. The plant establishment period will begin when the original planting and all landscape construction has been completed and approved. The length of the establishment period will be one calendar year or as defined in the permit Special Provisions.

11. Permittee shall install and maintain landscaped area. Planting shall be limited to low-growing shrubs, grass or flowers that do not attain sufficient height to obstruct clear vision in any direction. The Oregon Department of Transportation (ODOT) shall have the right to remove said landscaping at any time such removal may appear to be in the public interest, without liability or loss, injury, of damage or any nature whatsoever.

TRAFFIC

- √12. During construction or maintenance, the work area shall be protected in accordance with the current Manual on Uniform Traffic Control Devices, (MUTCD), Federal Highway Administration, US Department of Transportation, and the Oregon Department of Transportation supplements thereto. Flaggers must have a card or certificate indicating their completion of an approved work zone traffic control course. All traffic control devices shall be maintained according to the American Traffic Safety Services Association (ATSSA), Quality Standards for Work Zone Traffic Control Devices handbook.
13. Permittee shall provide a detailed traffic control plan for each phase of the work, showing signs and cones. Plans shall be reviewed and approved by Oregon Department of Transportation in advance of construction or maintenance.
- √14. All damaged or removed highway signs shall be replaced by the permittee. Installation shall be according to MUTCD standards or ODOT specifications and shall be completed as soon as possible but no later than the end of the work shift.
15. No lane restrictions are permitted on the roadway during the hours of darkness, on weekends, or between 6:00 AM and 9:00 AM, or 4:00 PM and 7:00 PM (Monday thru Thursday off by noon on Friday) without prior approval by ODOT.
- √16. Traffic control with lane restrictions are permitted on the roadway with the following guidelines:
See attached EXHIBIT: DISTRICT 4 LANE RESTRICTIONS, 01/01/2024.

DRAINAGE

17. On-site storm drainage shall be controlled within the permitted property. No blind connections to existing state facilities are allowed.
18. Excavation shall not be done on ditch slopes. Trench excavation shall either be at ditch bottom or outside ditch area. (Minimum depth at bottom of ditch shall be 36 inches; minimum depth outside of ditch shall be 42 inches).
19. Only earth or rock shall be used as fill material and shall slope so as not to change or adversely affect existing drainage. Fine grade and seed the finished fill with native grasses to prevent erosion.
20. A storm drainage study stamped by an Oregon Registered Professional Engineer (PE) is required. The study must meet standards of the National Pollution Discharge Elimination Systems (NPDES) when any of the following conditions apply:
- Whenever a four inch pipe is inadequate to serve the developed area,
 - development site is one quarter acre or larger in size, OR contributes one half cubic feet per second OR directly or indirectly affects state facilities,
 - or as directed by the District Manager or representative.
21. Permittee shall provide on-site retention for storm water runoff that exceeds that of the undeveloped site.

22. All water discharged to an ODOT drainage system must be treated prior to discharge. All requests for connection to an ODOT storm system must meet any requirements of the National Pollutant Discharge Elimination System (NPDES). This may include local jurisdiction approval of on-site water quality treatment facilities and/or development of an operation and maintenance plan for any on-site water quality treatment facility, as determined by local jurisdiction

EXCAVATION/CONSTRUCTION

- ✓23. The following ODOT documents and any supplements and subsequent revisions thereto, where applicable and not otherwise superseded by the permit language herein, but only to the extent that they provide standards and performance requirements for work to be performed under the permit, shall be incorporated for use in the permit: "Oregon Standard Specifications for Construction (2015)" and relevant Metric Standard Drawings. ODOT shall have authority over acceptance of all materials and workmanship performed under this permit as stated in Section 00150.00 of the "Oregon Standard Specifications for Construction (2015)." For additional Supplemental and Special Provisions please refer to: <http://www.odot.state.or.us/techserv/roadway/specs/home.htm>. Standard Specification books are available on this site.
- ✓24. Open cutting of pavement is allowed in areas specifically approved by District Manager or representative.
- ✓25. Trench backfill shall be according to the attached typical drawing, marked as Exhibit A.
- ✓26. Open cutting of the highway is allowed with construction in accordance with OAR 734-55-0100. All excavation in paved areas shall be backfilled and the roadway surface patched before the end of each shift. In special cases where steel plates are allowed, said plates shall be pinned and a temporary cold patch applied to the edges. The permittee shall be fully responsible for monitoring and maintenance of temporary patching and steel plating.
- ✓27. Compaction tests shall be required for each open cut per Oregon Standard Specification for Construction. Compaction tests shall be conducted once for every 300 lineal feet per lift of continuous trench according to the Manual of Field Test Procedures (MFTP), published by ODOT. Percent Compaction shall be 95%. At the discretion of the District Manager or representative, results of compaction test shall be provided to District Manager or representative at applicants' expense.
- ✓28. Control Density Fill (CDF) shall be used as surface backfill material in place of crushed rock in open trenches that impact the travel portions of the highway. A ¾"-0, or 1"-0 rock will be used for the aggregate. The amount of cement used shall not exceed 3.0% of the total mixture's weight. Maximum compressed strengths must not exceed 250 pounds per square inch (psi).
- ✓29. Surface restoration shall be a minimum of eight inches of hot asphalt-concrete (AC), compacted in two inch lifts, or match existing pavement depth, whichever is greater. Sand-seal all edges and joints.
- ✓30. All aggregate shall conform to Oregon Standard Specification for Construction, Section 02630 - Base Aggregate.
- ✓31. Any area of cut or damaged asphalt shall be restored by the applicant (call ODOT for restoration requirements). For a period of two years following the patching of paved surface, permittee shall be responsible for the condition of permittee's pavement patches, and during that two-year period shall repair to District Manager or representative satisfaction any of the patches which become settled, cracked, broken, or otherwise faulty.
- ✓32. An overlay to seal an open-cut area shall be completed prior to the end of the construction season, or when minimum temperature allows per "Oregon Standard Specification for Construction" and any subsequent revisions thereto. Typical overlay shall be 1.5 inches deep and cover the affected area from edge of pavement to edge of pavement, and taper longitudinally at a fifty feet to one inch (50' : 1") ratio. Taper may be adjusted by the District Manager as required.

For a period of two years following this patching of the surface, the permittee shall be responsible for the condition of said pavement patches, and during that time shall repair to the District Manager or representative's satisfaction any of the patches which become settled, cracked, broken or otherwise faulty.

- √33. Highway crossings shall be bored or jacked. Bore pits shall be located behind ditch line or in areas satisfactory to the District Manager. Unattended pits shall either be protected by a six-foot fence, backfilled, or steel plated and pinned.
- √34. Permittee shall install a "tracer wire" or other similar conductive marking tape or device, if installing any non-conductive, unlocatable underground facility, in order to comply with Oregon Utilities Coordination Council (OUCC), per OAR 952-01-0070 (6).
- 35. Trench backfill outside of ditch line or in approved areas can be native soil compacted at optimum moisture in twelve inch layers to 90% or greater of the maximum density.
- √36. Native material that is found to be unsatisfactory for compaction shall be disposed of off the project and granular backfill used.
- 37. Trench backfill in rock slope or shoulder shall be crushed 1"-0 or ¾"-0 size rock compacted at optimum moisture in eight-inch layers. Compaction tests shall be conducted according to the Manual of Field Test Procedures (MFTP), published by ODOT. Percent compaction shall be 95%. At the discretion of the District Manager or representative, results of compaction tests shall be provided to District Manager or representative at applicant's expense.
- 38. Where excavation is on fill slope steeper than a two to one (2:1) ratio, slope protection shall be provided using four-inch size rock laid evenly to a minimum depth of twelve inches.
- √39. No more than 300 feet of trench longitudinally along the highway shall be left open at any one time and no trench shall be left in an open condition overnight (during non work hours).
- 40. Areas of disturbed cut and fill slopes shall be restored to a condition suitable to the District Manager or representative. Areas of erosion to be inlaid with an acceptable riprap material.
- √41. All underground utilities shall be installed with 10' or more of horizontal clearance from existing or contract plans guardrail posts and attachments. All non-metallic water, sanitary and storm sewer pipe shall have an electrically conductive insulated Number 12-gauge copper tracer wire the full length of the installed pipe using blue wire for water and green for storm and sanitary sewer piping.
- √42. Any area of cut or damaged concrete shall be restored in accordance with the attached Typical Section-Pipe Section under sidewalk. If not attached, contact ODOT District 4 for specifications and requirements.
- √43. No utility markers or pedestals shall be placed in the highway right-of-way.
- √44. No cable plowing is allowed within the lateral support of the highway asphalt (i.e. at six feet lower than the edge of the asphalt, no plowing within nine feet of the edge of the asphalt).
- 45. Review by ODOT Bridge Engineers is required for all proposed bridge and structure attachments and for utility or any facilities to be installed within sixteen feet of bridge foundations, supports, and walls or related, or within the influence zone of bridge facilities.

- √46. Permittee shall be responsible and liable for (1) investigating presence/absence of any legally protected or regulated environmental resource(s) in the action area; (2) determining any and all restrictions or requirements that relate to the proposed actions, and complying with such, including but not limited to those relating to hazardous material(s), water quality constraints, wetlands, archeological or historic resources(s) state and federal threatened or endangered species, etc., (3) complying with all federal, state, and local laws, and obtaining all required and necessary permits and approvals.
- √47. If the permittee impacts a legally protected/regulated resource, permittee shall be responsible for all costs associated with such impact, including, but not limited to all costs of mitigation and rehabilitation, and shall indemnify, and hold ODOT harmless for such impacts and be responsible and liable to ODOT for any associated costs or claims that ODOT may have.
- √48. Plans are approved by ODOT in general only and do not relieve the permittee from completing construction improvements in a manner satisfactory to ODOT. The District Manager or representative may require field changes. When revisions are made in the field, permittee is responsible to provide "as built" drawings, within 60 days from completion of highway improvements, and shall submit them to the District Office issuing the permit.
- √49. Permittee shall be responsible for locating and preserving all existing survey monumentation within the work area in accordance with ORS 209.150 and/or 209.155. If monumentation or its accessories are inadvertently or otherwise disturbed or destroyed, applicant shall be responsible for all costs and coordination associated with it's reestablishment by a professional licensed surveyor.

SPECIAL PROVISIONS

- √50. Any areas of damaged curb and/or sidewalk shall be restored to a like new condition. All damaged sections shall be saw-cut to the next joint and the panel replaced in its entirety. If the highway surface or highway facilities are damage by the applicant, applicant shall replace or restore the highway or highway facilities to a condition satisfactory to ODOT, whether discovered at the time of installation or at a later date. ODOT may have the applicant replace or restore the highway or highway facilities to a condition satisfactory to be determined by ODOT. ODOT may choose to replace or restore the highway or highway facilities by contractor or state forces and the costs incurred to be paid by the applicant under the terms outlined in OAR 734-055-0020(2). The contractor will be notified of the damages and given 48 hours to comply. In those situations where public safety has been impaired no notice will be given. CALL THE ODOT CONTACT LISTED ON PAGE 1 OF THIS PERMIT FOR PAVEMENT RESTORATION REQUIREMENT.
- √51. NO UNPROTECTED CLEATS ON THE ASPHALT. Any damages resulting from the applicant's operations shall be immediately identified on the road in a manner approved by Authorized Officer, until repairs are made to the satisfaction of the ODOT District Manager or his/her representatives. Any damage to the asphalt surface or shoulder shall be temporarily repaired within 24 hours. Track cleats may be accepted upon request provided that plywood, tires, or any other acceptable means can protect the asphalt.
- √52. All equipment shall be parked off the right-of-way or in areas acceptable to the ODOT District Manager or ODOT representative.
- √53. Work site shall be restored to "as found" or better condition.

54. All work, including bore pits are to be located outside of the Interstate Highway right of way. The only permitted work within the right of way is the boring of utilities.
- √55. ODOT Station 2 Contact Requirements:
When traffic control is required that disrupts, diverts, or may cause traffic impacts or delays contact ODOT Station 2 at 503-362-0457. You will need to provide a contact name, phone number, the highway, mile point, type of work and how long traffic will be affected.
- √56. Work is approved per the attached plan. Any deviation from the plan requires ODOT approval prior to construction. If this service is removed, it is to be removed in its entirety.
- √57. An abandoned utility facility is defined here as a facility that is no longer in used by the applicant. The abandoned facility is still owned by the applicant and is required to be located when utility locates are requested at the location of an abandoned facility. Applicant shall be responsible for all future maintenance and locates of abandoned facility located under pavement. If future highway development requires the removal of the abandoned facility, facility will be removed by applicant and/or at applicant's expense. Abandonment of facility NOT under paved surface will not be allowed, facility will be removed by applicant and/or at applicants expense.
- √59. Special Lane Closure Restrictions:
No *Holiday Weekend* lane closures.
If the holiday falls on a Monday, the holiday weekend would be from noon on Friday – midnight on Monday.
If the holiday falls on a Thursday, the holiday weekend would be from noon on Wednesday – midnight on Sunday. OFF highway by noon on Friday.
- √60. All utility facilities that are not at a minimum of 42" deep need to be located 3' or less to the right of way property line (and outside of the highway maintenance area). If it is not possible to locate such utilities in this location, a detail sheet that includes the type of facility, location and verbiage stating the reason of the location must be submitted to ODOT for review and written approval. These detail sheets/plans are required by ODOT, District 4 to be approved individually by ODOT and approved sheets/plans must contain an ODOT stamp of approval as part of the permit.
- √61. ADA:
Permittee shall take measures necessary to maintain the accessibility of the state highway by individuals with disabilities to the current ADA standard during the course of the permitted work by following the latest version of the Oregon Temporary Traffic Control Handbook section 1.6.
Permittee shall ensure that advance notice of any temporary pedestrian route is provided in an accessible format to the public, people with disabilities, and disability organizations to the greatest extent possible. The Notice is to be sent to the organizations on the contact list for Centers for Independent Living at:
CenterContactInformationJanuary2019.pdf (oregon.gov)
Permittee shall be responsible to restore or replace any curbs or curb ramps damaged by the permitted activity according to ODOT's ADA Standards available at
<https://www.oregon.gov/ODOT/Engineering/Pages/Accessibility.aspx>.
ADA standards in place at the time a permit is issued are to be met when a permit is issued for: Repair or installation of new sidewalk, curb, crosswalk, or a median that includes a pedestrian walkway. Work that damages (removes or cuts into or through) an existing curb or curb ramp. ADA Curb and Curb Ramp Upgrades on Utility Permits MG 14-05 Work that damages a curb or sidewalk where no ramp exists but where there is a crosswalk or is at an intersection where pedestrians would be expected to cross the highway even if there is no crosswalk in place. Work that requires the replacement of any part of the curb or curb ramp including the pan of the curb ramp.
Acceptance of Work shall be by Specially trained ODOT staff is to inspect curb ramps prior to acceptance of the permitted work to ensure the curb or curb ramp meets ADA standards. Should the ADA accommodations not be

Acceptance of Work shall be by Specially trained ODOT staff is to inspect curb ramps prior to acceptance of the permitted work to ensure the curb or curb ramp meets ADA standards. Should the ADA accommodations not be satisfactorily completed, ODOT will notify the permit applicant in writing. The permit applicant will be responsible to take corrective action in the time and manner prescribed by ODOT.

Any review or inspection of the curbs or curb ramps conducted by ODOT does not relieve the Permittee of the responsibility to comply with any other aspect of federal, state, and local laws, rules and regulations applicable to the work allowed under the permit including but not limited to the Americans with Disabilities Act of 1990.

- √62. Construction, work, and maintenance are the applicant's sole responsibility. ODOT will not be responsible for any costs associated with this work.
- √63. Contact ODOT at 541-757-4211 to discuss questions or concerns regarding this permit. Any changes or part of the permit that the applicant does not understand or agree with, must be changed or worked out prior to commencing the work.
- √64. Contact ODOT permits staff at 541-757-4211 to schedule an onsite meeting to mark out pavement restoration, and details prior to paving.

DISTRICT 4 LANE RESTRICTIONS

| Route No. | Highway No. | Milepoint | LANE RESTRICTIONS | | | | | | |
|-----------|-------------|--------------------|--------------------------|----------------------------|----------------------|---------------------|--------------------------|---|------------------------------|
| | | | No Commute Time Closures | Off Hwy by 12 PM On Friday | No Closure On Friday | No Weekend Closures | Nights Only (7 PM - 6AM) | Nights Only (7PM - 6AM) High Traffic Season | Nights Only (9 PM - 5:30 AM) |
| I-5 | 001 | 209.06 - 244.68 | | | | X | | | X |
| | 001MV | Airport Rd, Albany | | | | | X | | |
| | 001NA | Century Dr, Albany | X | | | | | | |
| US 101 | 009 | 91.46 - 105.90 | | X | | X | | | |
| US 101 | 009 | 105.90 - 144.37 | | | X | | X | | |
| US 101 | 009 | 144.37 - 167.61 | X | | X | X | | | |
| US 20 | 016 | 0.00 - 1.96 | | | | | X | | |
| US 20 | 016 | 1.96 - 32.98 | X | X | | | | | |
| OR 34 | 027 | 39.81 - 58.56 | X | | | | | | |
| US 20 | 031 | 0.00 - 11.23 | | | X | | X | | |
| OR 22 | 032 | 10.63 - 22.01 | X | | | X | | | |
| US 20 | 033 | 0.00 - 5.75 | | | X | | X | | |
| US 20 | 033 | 5.75 - 49.76 | X | X | | X | | | |
| US 20 | 033 | 49.76 - 56.80 | | | X | | X | | |
| OR 18 | 039 | 0.00 - 21.18 | X | | X | X | | X | |
| OR 99E | 058 | 0.00 - 5.81 | | | X | | X | | |
| OR 99E | 058 | 5.81 - 7.90 | X | X | | | | | |
| OR 99W | 091/1W | 63.42 - 73.75 | X | X | | | | | |
| OR 99W | 091/1W | 73.75 - 82.59 | | | X | | X | | |
| OR 99W | 091/1W | 82.59 - 104.36 | X | X | | | | | |
| OR 99E | 164 | 0.00 - 5.28 | X | | | | | | |
| OR 99E | 164 | 5.28 - 8.39 | X | | X | | | | |
| OR 229 | 181 | 23.48 - 31.24 | X | | | | | | |
| OR 223 | 191 | 4.73 - 9.95 | X | | | | | | |
| OR 200 | 200 | 0.00 - 2.03 | X | | | | | | |
| OR 34 | 210 | 0.00 - 1.19 | | | | | X | | |
| OR 34 | 210 | 1.19 - 7.64 | X | X | | | | | |
| OR 34 | 210 | 7.64 - 10.77 | | | | | X | | |
| OR 34 | 210 | 10.77 - 18.13 | X | X | | | | | |
| OR 228 | 212 | 0.00 - 21.46 | X | | | | | | |

DISTRICT 4 LANE RESTRICTIONS 04M55208

| Route No. | Highway No. | Milepoint | LANE RESTRICTIONS |
|-----------|-------------|---------------|--|
| | | | No Restrictions on This Section of Highway |
| OR 20 | 16 | 32.98 - 71.50 | X |
| OR 34 | 27 | 0.00 - 39.87 | X |
| OR 99E | 58 | 7.90 - 28.22 | X |
| OR 180 | 180 | 0.00 - 19.25 | X |
| OR 229 | 181 | 0.00 - 23.48 | X |
| OR 223 | 191 | 9.95 - 31.40 | X |
| OR 194 | 194 | 0.00 - 7.56 | X |
| OR 201 | 501 | 0.00 - 9.49 | X |
| OR 226 | 211 | 0.00 - 25.71 | X |

Definitions:

Commute Times: 6 AM to 9 AM and 4 PM to 7 PM, Monday - Friday
 High Traffic Season: March 15 - April 15 and June 1 - November 1
 Night Work Hours: 7 PM to 6 AM (I-5 only: 9 PM to 5:30 AM)
 Closures: Reduction of travel lanes
 Weekend: 12 AM Friday - 7 PM Sunday
 Holiday: The day before the holiday, and the day after the holiday. To include the holiday weekend and all days in-between.
Example 1 - Holiday falls on a Monday, the closure can not be between 6 AM Saturday - 9 PM Tuesday.
Example 2 - Holiday falls on a Thursday, the closure can not be between 6 AM Wednesday - 9 PM Sunday.

General Restrictions:

- 1.) No Holiday Weekend Closures
- 2.) Even during restricted times, one lane in each direction must remain open at all times on multi-lane highways.
- 3.) Traffic control must meet MUTCD and Oregon Temporary Traffic Control Handbook guidelines.
- 4.) Daytime work may be allowed in multi-lane sections with prior approval

ODOT Deviations:

- 1.) Any deviation from this document must be requested in writing and have written approval by ODOT, District 4.
- 2) Changes and/or more restrictions to work times may be added if ODOT observes traffic congestion or conditions that warrant a change.
- 3) Contact ODOT, District 4 at 541-757-4211 with questions or concerns.

EXHIBIT A

"T"-CUT RESTORATION IN THE TRAVEL LANE/SHOULDER

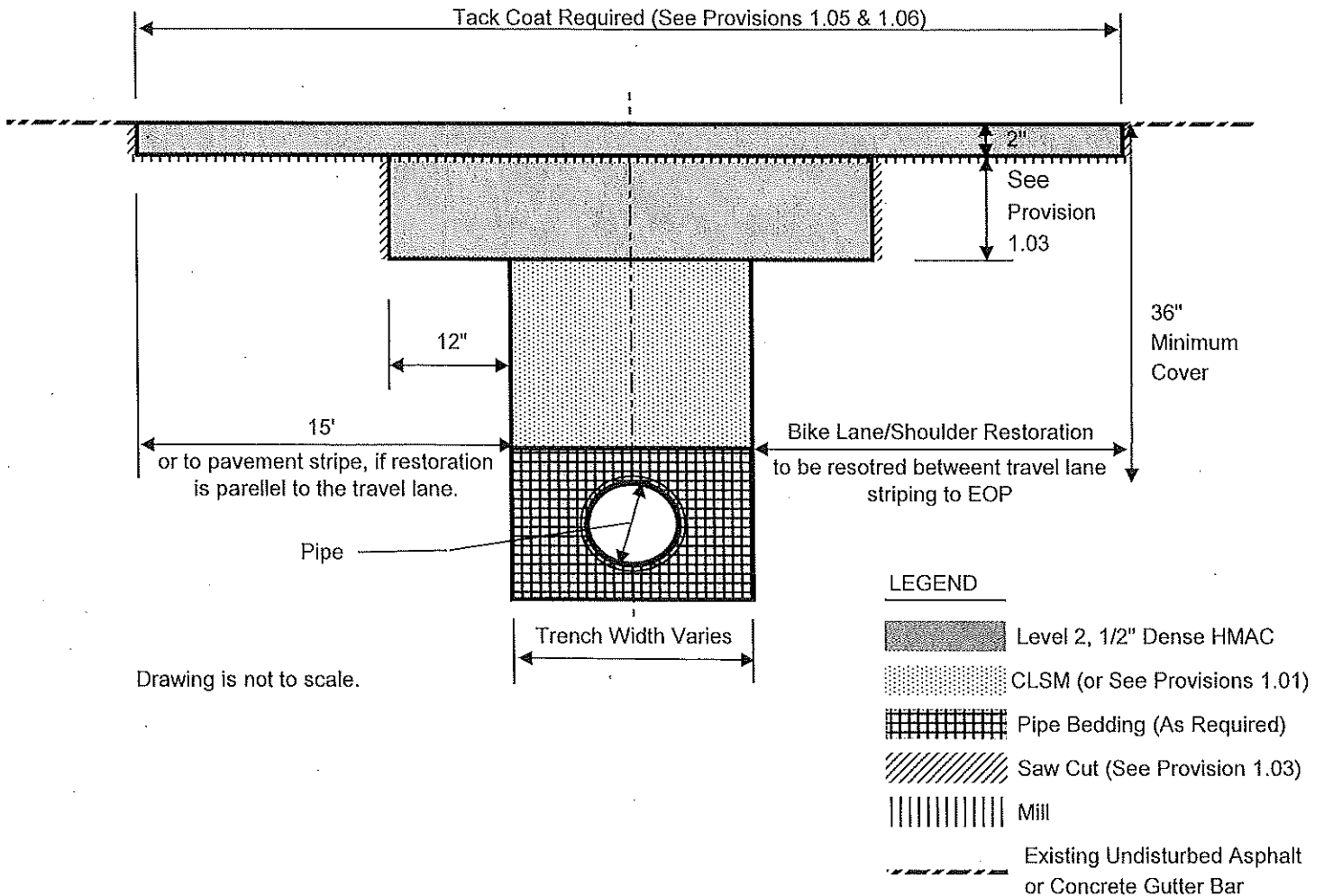

1.00 Special Provisions (T-Cut Restoration Requirements)

- 1.01 CLSM or backfill material shall be sand blend trench fill with 3/4" rock compacted to a minimum of 95% of the maximum density of the material placed in 6" lifts.
- 1.02 Joints in the travel lane are to be at the curb & gutter, centerline or skip line, and/or at the nearest longitudinal joint.
- 1.03 All cuts in pavement shall be full depth saw cuts. A minimum compacted thickness of 6" or the thickness of the removed pavement, whichever is greater. Pavement to be compacted in 3" lifts.
- 1.04 Cut areas shall be cold patched at the end of the workday and patch maintained. Cold patched areas shall be hot patched within 10 days. All cold patch material to be excavated prior to hot patch restoration.
- 1.05 Pavement grinding shall conform to Standard Specifications for Highway Construction, Cold Plane Pavement Removal. Pavement surface shall be uniformly milled using equipment that is capable of accurately establishing profile grades within a tolerance of 1/4" (or 6mm) by reference from either the existing pavement or independent grade control. Parallel trench restoration will start/stop 5' before and beyond trench.
- 1.06 Asphalt emulsion tack coat shall be used to seal the ground area to the edges of the existing asphalt. All cut areas shall be sealed with an ODOT approved polymer asphalt sealant.
- 1.07 All existing pavement markings and legends are to be restored with like kind.
- 1.08 Applicant shall accept responsibility for pavement stress or settlement of the "T"-Cut restoration section for a period of 2 years from the specified completion date listed on page 1 of the permit.

CITY OF ALBANY

SS-25-01, COX CREEK INTERCEPTOR SEWER PHASE 3

04M55208

- SHEET INDEX**
- SHEET NO. 1 COVER & GENERAL NOTES
 - SHEET NO. 2 SEWER CONSTRUCTION ACROSS INTERSTATE 5
 - SHEET NO. 3 SEWER CONSTRUCTION ON AIRPORT ROAD

| LEGEND | |
|--------|---------------------------------------|
| | EXISTING WATER SERVICE |
| | RECONNECT EXISTING METER |
| | INSTALL NEW SERVICE METER |
| | REPLACE EXISTING METER WITH NEW METER |
| | AIR RELEASE VALVE |
| | EXISTING WATER VALVE |
| | NEW WATER VALVE |
| | EXISTING WATER LINE |
| | EXISTING GAS LINE |
| | EXISTING STORM LINE |
| | EXISTING SANITARY SEWER LINE |
| | EXISTING CUL DUCT LINE |
| | EXISTING POWER LINES |
| | NEW WATER LINE |
| | NEW STORM LINE |
| | NEW STORM DRAIN MANHOLE CLEARANCE |
| | NEW STORM DRAIN MANHOLE |
| | EXISTING POWER POLE |
| | EXISTING STORM MANHOLE |
| | NEW CURB INLET |
| | NEW CATCH BASIN |
| | NEW CURB INLET |
| | NEW CATCH BASIN |
| | EXISTING STREET LIGHT |
| | EXISTING TRAFFIC SIGN |
| | NEW TRAFFIC SIGN |
| | EXISTING HYDRANT |
| | NEW HYDRANT |
| | REDUCER |

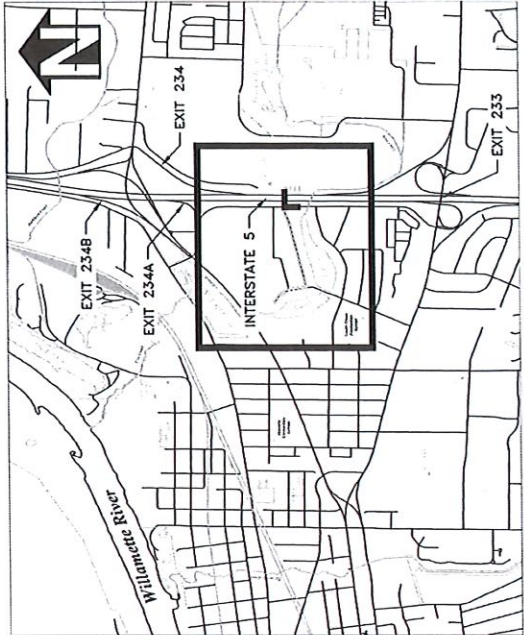
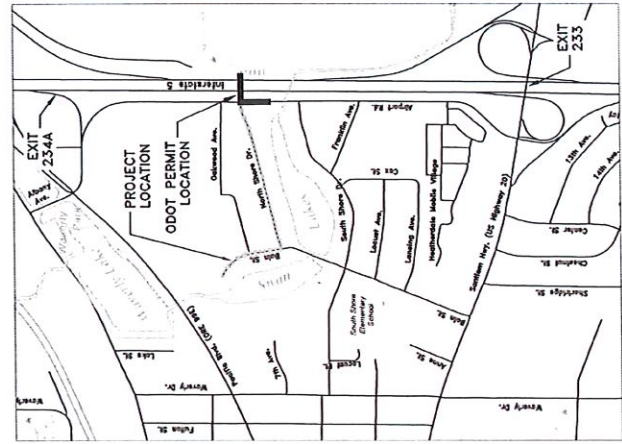

Vicinity Map
Not to Scale

GENERAL NOTES

1. ALL CONSTRUCTION SHALL CONFORM TO THE CITY OF ALBANY STANDARD CONSTRUCTION SPECIFICATIONS AND ASSOCIATED STANDARD DRAWINGS. THE CURRENT VERSION OF THE CITY OF ALBANY STANDARD CONSTRUCTION SPECIFICATIONS CAN BE FOUND ON THE CITY'S WEBSITE AT WWW.CITYOFALBANY.NET.
2. UTILITIES SHOWN ARE FOR REFERENCE ONLY. FOR A FIELD LOCATE, CALL THE UTILITIES NOTIFICATIONS CENTER AT 1-800-532-2344.
3. OPERATING ACCESS FOR CITY MAINTENANCE PERSONNEL TO EXISTING AND NEW WATER VALVES AND MANHOLES SHALL BE CONTINUOUSLY MAINTAINED BY THE CONTRACTOR DURING ALL CONSTRUCTION ACTIVITIES.
4. CONTRACTOR SHALL VERIFY ALL EXISTING PIPE ELEVATIONS, PIPE DIAMETERS, AND PIPE MATERIALS AT CONNECTION AND ABANDONMENT LOCATIONS PRIOR TO CONSTRUCTION. ANY DISCREPANCIES SHALL BE REPORTED TO ENGINEER PRIOR TO BEGINNING WORK.
5. ATTENTION: OREGON LAW REQUIRES YOU TO FOLLOW RULES ADOPTED BY THE OREGON UTILITY NOTIFICATION CENTER. THOSE RULES ARE SET FORTH IN OAR 952-001-0010 THROUGH OAR 952-001-0090. YOU MAY OBTAIN COPIES OF THE RULES BY CALLING THE CENTER. (NOTE: THE TELEPHONE NUMBER FOR THE OREGON UTILITY NOTIFICATION CENTER IS (503) 232-1987).
6. CONTRACTOR SHALL BE RESPONSIBLE FOR PROPER INSTALLATION AND MAINTENANCE OF ALL EROSION PREVENTION SEDIMENT CONTROL (EPSC) MEASURES IN ACCORDANCE WITH LOCAL, STATE, AND FEDERAL REGULATIONS UNTIL ALL CONSTRUCTION IS COMPLETED AND APPROVED BY THE CITY OF ALBANY, AND VEGETATION/LANDSCAPING IS ESTABLISHED. FOR GUIDANCE, REFER TO THE CITY OF ALBANY EPSC MANUAL WHICH CAN BE FOUND AT WWW.CITYOFALBANY.ORG.

| DATE | NO. | BY | REVISIONS |
|------------|-----|----|-----------|
| 12/28/2023 | | | |
| | | | |
| | | | |
| | | | |

DESIGNED: C. CERKLEWSKI
 DRAWN: C. CERKLEWSKI
 CHECKED: N. NELSON
 DATE: 12/28/2023

SS-25-01, COX CREEK INTERCEPTOR SEWER PHASE 3

PUBLIC WORKS DEPARTMENT
ENGINEERING SERVICES

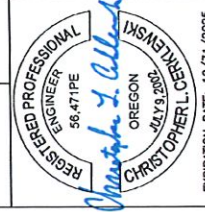

EXPIRATION DATE: 12/31/2025
 SHEET NO. 1 OF 3
 PROJECT NO: SS-25-01
 FILE: COVER.DWG

04M55208

NOTE: MAINTAIN THROUGH TRAFFIC ON AIRPORT ROAD AT ALL TIMES TO CONTROL TRAFFIC THROUGH ONE LANE.

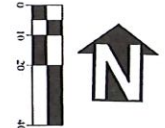
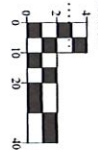
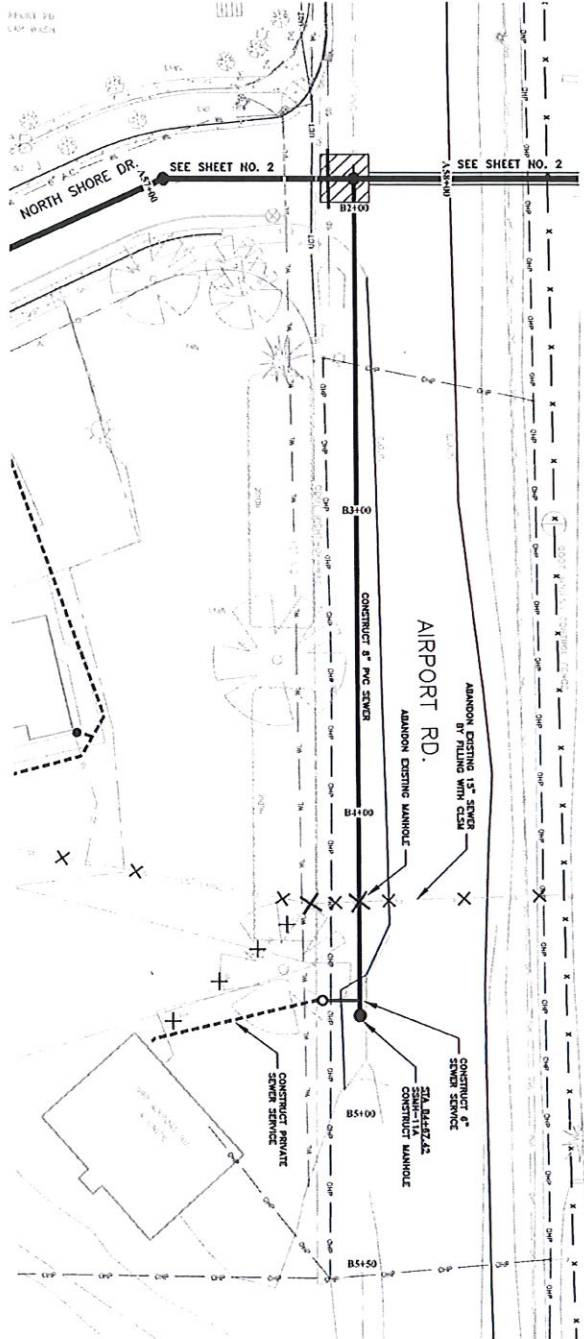
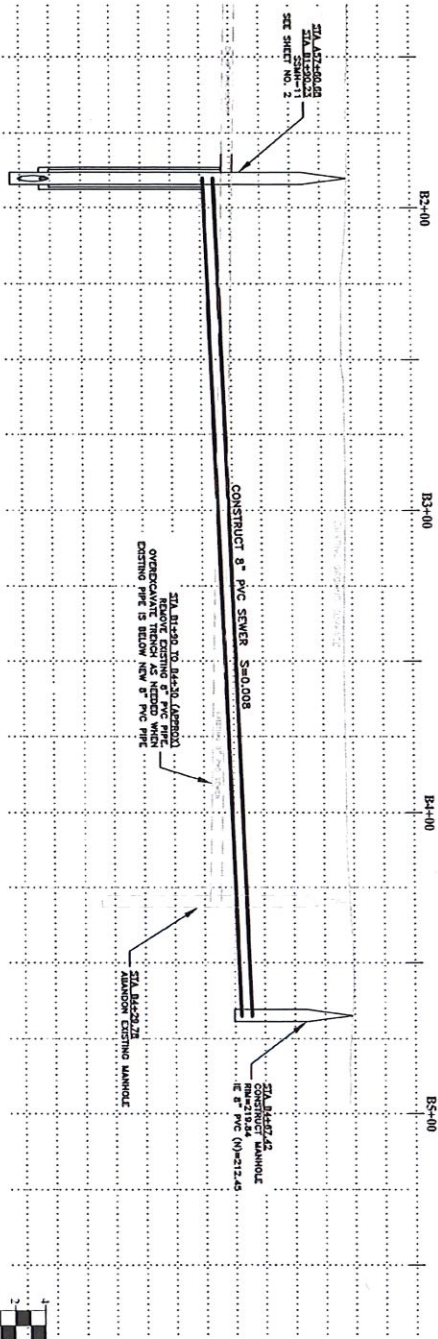

REGISTRED PROFESSIONAL ENGINEER
 56,471 PE
 CHRISTOPHER L. CERKLEWSKI
 OREGON
 EXPIRATION DATE: 12/31/2025
 SHEET NO. 3 OF 3
 PROJECT NO: SS-25-01
 FILE: BASE.DWG



**PUBLIC WORKS DEPARTMENT
 ENGINEERING SERVICES**

**SS-25-01, COX CREEK INTERCEPTOR SEWER PHASE 3
 AIRPORT ROAD SEWER CONSTRUCTION**

DESIGNED: C. CERKLEWSKI
 DRAWN: C. CERKLEWSKI
 CHECKED: N. NELSON
 DATE: 12/28/2023

| REVISIONS | | |
|-----------|-----|-----|
| DATE: | NO: | BY: |
| | | |
| | | |
| | | |
| | | |

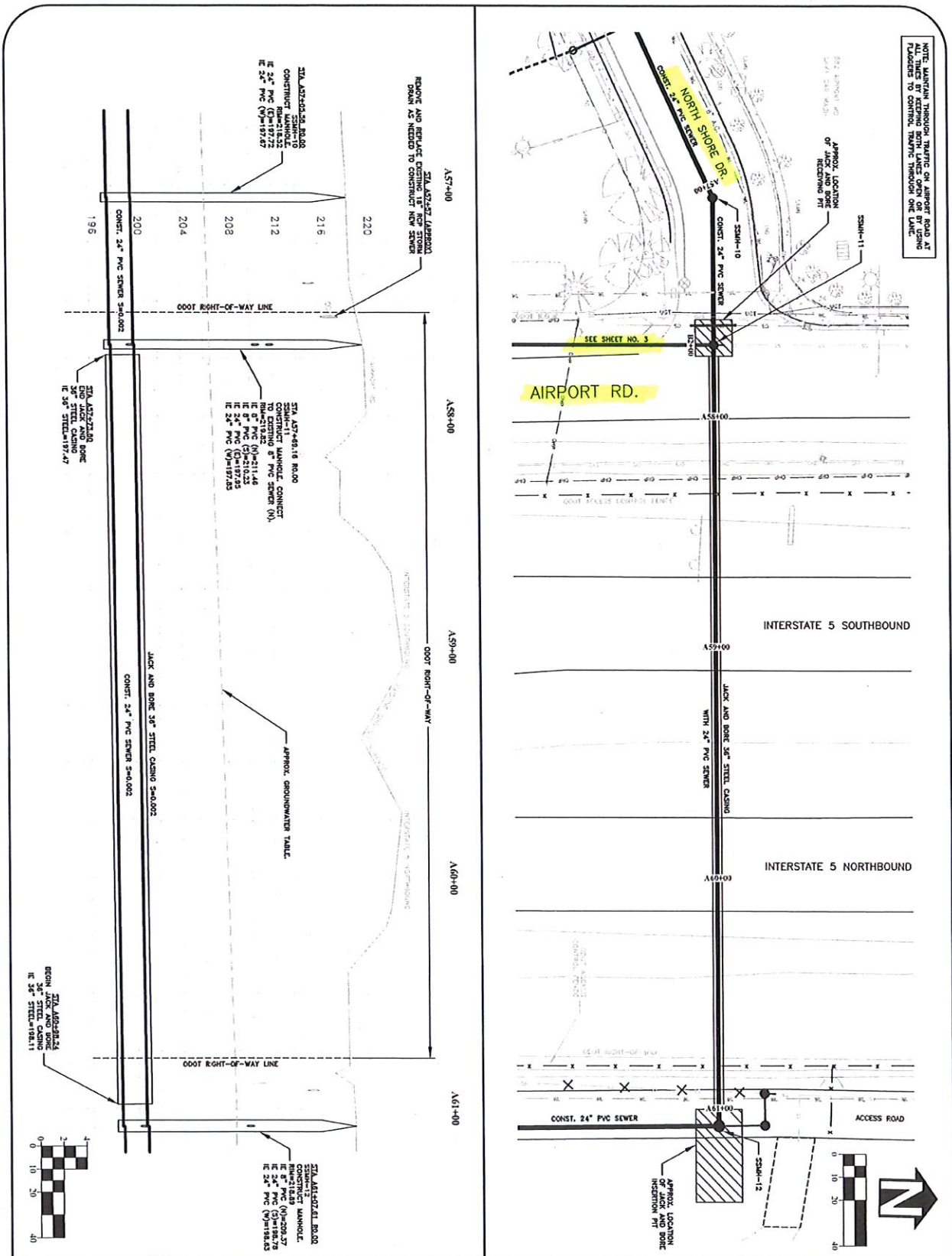

NOTE: MAINTAIN THROUGH TRAFFIC ON AIRPORT ROAD AT ALL TIMES. TRAFFIC CONTROL AND TRAFFIC SIGNALS TO BE PROVIDED TO CONTROL TRAFFIC THROUGH ONE LANE.

REPORT AND REPAIRS EXISTING 18" CP STORM DRAIN AS NEEDED TO CONSTRUCT NEW SEWER

STA. A57+00.00
CONST. 24" PVC SEWER S=0.002

220
215
212
208
204
200
195

OOOT RIGHT-OF-WAY LINE

APPROX. GROUNDWATER TABLE

JACK AND BORE 36" STEEL CASING S=0.002
CONST. 24" PVC SEWER S=0.002

STA. A57+00.18 R.O.D.
CONSTRUCT MANHOLE
R.O.D. (M)=209.27
R.O.D. (S)=192.78
R.O.D. (W)=198.85
IE 24" PVC (M)=17.25
IE 24" PVC (S)=17.25
IE 24" PVC (W)=17.25

SMH-11
CONSTRUCT MANHOLE
R.O.D. (M)=211.48
R.O.D. (S)=201.52
R.O.D. (W)=197.47
IE 24" PVC (M)=17.48
IE 24" PVC (S)=17.48
IE 24" PVC (W)=17.47

STA. A57+21.00
CONSTRUCT JACK AND BORE
R.O.D. (M)=197.47
R.O.D. (S)=197.47
R.O.D. (W)=197.47
IE 36" STEEL=197.47

STA. A61+02.00 R.O.D.
CONSTRUCT MANHOLE
R.O.D. (M)=209.27
R.O.D. (S)=192.78
R.O.D. (W)=198.85
IE 24" PVC (M)=17.25
IE 24" PVC (S)=17.25
IE 24" PVC (W)=17.25

DESN STA. A61+18.24
CONSTRUCT JACK AND BORE
R.O.D. (M)=198.11
R.O.D. (S)=198.11
R.O.D. (W)=198.11
IE 36" STEEL=198.11

SHEET NO. 2 OF 3
PROJECT NO. SS-25-01
FILE: BASE.DWG

REGISTERED PROFESSIONAL ENGINEER
56,471 PE
CHRISTOPHER L. CERKLEWSKI
OREGON
EXPIRATION DATE: 12/31/2025



PUBLIC WORKS DEPARTMENT
ENGINEERING SERVICES

SS-25-01, COX CREEK INTERCEPTOR SEWER PHASE 3
SEWER CONSTRUCTION

DESIGNED: C. CERKLEWSKI
DRAWN: C. CERKLEWSKI
CHECKED: N. NELSON
DATE: 12/11/2023

| REVISIONS | | |
|-----------|-----|-----|
| DATE: | NO: | BY: |
| | | |
| | | |
| | | |
| | | |

04M55208

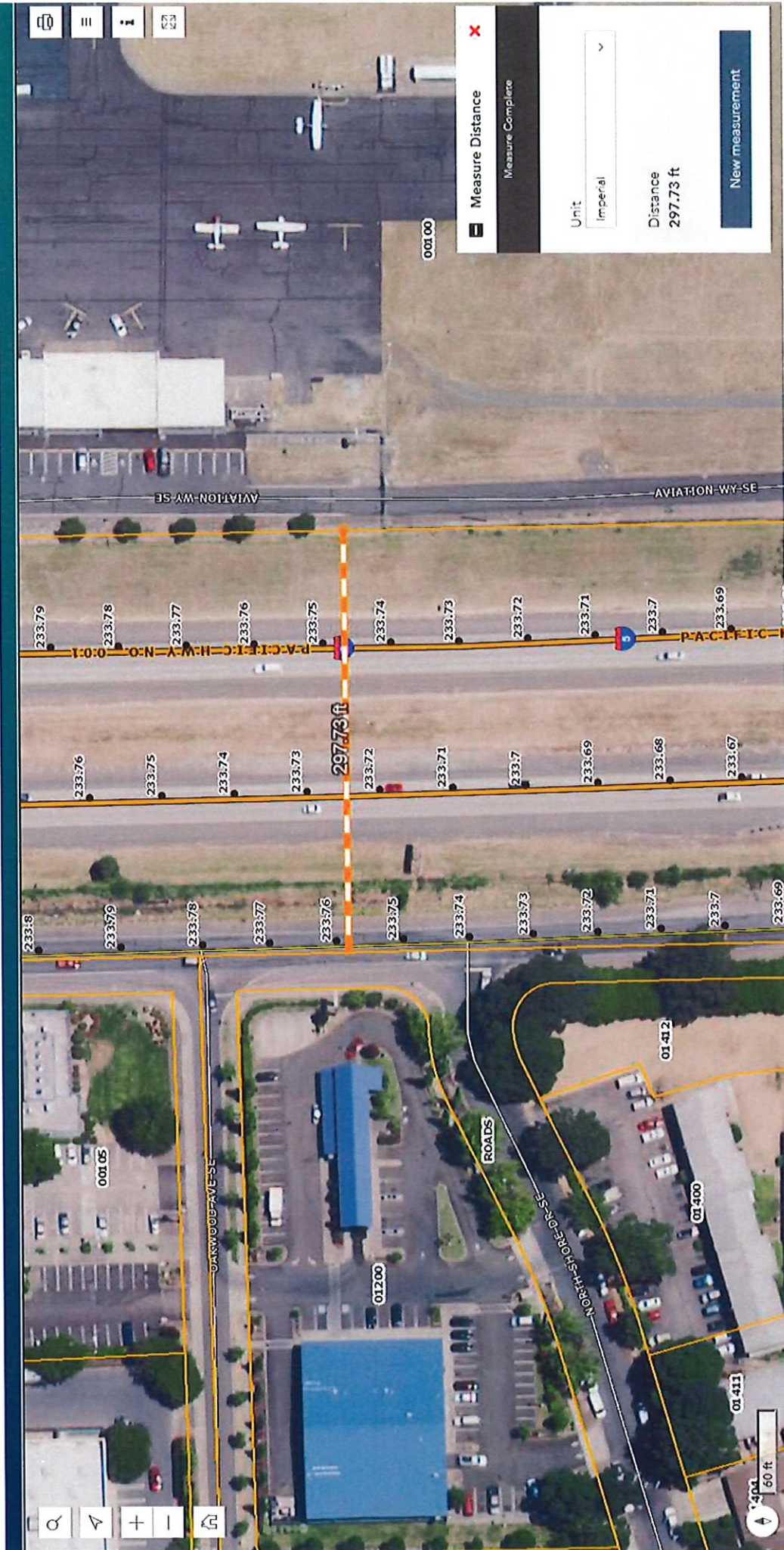

Measure Distance ✕

Measure Complete

Unit: Imperial

Distance: 297.73 ft

New measurement

60 ft

| VENDOR NUMBER | VENDOR NAME | CHECK NUMBER | CHECK DATE | CHECK AMOUNT |
|---------------|---------------------------|--------------|------------|--------------|
| 1884 | STATE OF OREGON TRANSPORT | 313004 | 02/15/2024 | \$20,000.00 |

| INVOICE DATE | INVOICE NUMBER | DESCRIPTION | INVOICE AMOUNT |
|--------------|----------------|--|----------------|
| 02/12/2024 | FEB 2024 | SS-25-01 COX CREEK INTERCEPTER SEWER PHASE 3 PO #: 24002406 - PUBLIC WORKS GL #: 60140350-820131 . | \$20,000.00 |

FINANCE
 PO Box 490
 Albany, Oregon 97321-0144

04M55208

Presort
 First Class Mail
 CombisPrice

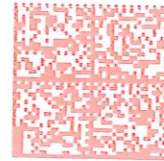

US POSTAGESM PITNEY BOWES
 ZIP 97301 \$ 000.57¹
 02 4W
 0000383149 FEB 15 2024

OREGON DEPT OF TRANSPORTATION
 ATTN: PERMIT'S STAFF
 3700 SW PHILOMATH BLVD
 CORVALLIS, OR 97333

4-2024 97303



DO NOT ACCEPT UNLESS THIS CHECK IS PRINTED WITH A PRISMATIC BACKGROUND, CONTAINS A VOID PANTOGRAPH, MICROPRINTING FACE AND BACK, UV FIBERS AND A WATERMARK ON THE REVERSE SIDE



City of Albany
 333 Broadalbin St. SW
 Albany, OR 97321
 (541) 917-7523

US Bank
 Albany, OR

Vendor Number
 1884

Check Number
 313004

Check Date
 02/15/2024

VOID 90 DAYS FROM DATE OF ISSUE

*** Twenty Thousand Dollars And Zero Cents ***

\$20,000.00

1884
 STATE OF OREGON TRANSPORT
 DIVISION/PROGRAM & FUNDING
 355 CAPITOL ST NE RM 212
 SALEM, OR 97301-3872

Authorized Signature: *[Signature]* MP
 Authorized Signature: *[Signature]* MP
 Authorized Signature: *[Signature]* MP

FIRESTONE James C

From: WAHL Carla S
Sent: Tuesday, January 2, 2024 9:42 AM
To: Cerklewski, Chris; DETERING Lynn S; FIRESTONE James C
Subject: RE: Permit Application (Interstate 5)
Attachments: ODOT Permit Application.SS-25-01.pdf

Chris,

Thank you for your request for permit. I want to take this opportunity to introduce you to James Firestone, he is working a rotational position in our District permitting office.

Please add James to all future permitting requests, as he will be responsible for printing off and processing your miscellaneous or utility permits. In addition to sending requests to James, please continue to copy Lynn, & myself as well.

Thank you!

*Carla Wahl
Permit Specialist
Oregon Department of Transportation
3700 S.W. Philomath Blvd.
Covallis, OR 97333
541-757-4211 District Office
541-757-4182 Direct Line Monday & Tuesday
<http://www.oregon.gov/ODOT/HWY/OOM/Pages/permits.aspx>*

From: Cerklewski, Chris <Chris.Cerklewski@albanyoregon.gov>
Sent: Thursday, December 28, 2023 11:04 AM
To: SAGERS Thomas Tom <Thomas.SAGERS@odot.oregon.gov>; DETERING Lynn S <Lynn.DETERING@odot.oregon.gov>; WAHL Carla S <Carla.S.WAHL@odot.oregon.gov>
Subject: Permit Application (Interstate 5)

Some people who received this message don't often get email from chris.cerklewski@albanyoregon.gov. [Learn why this is important](#)

This message was sent from outside the organization. Treat attachments, links and requests with caution. Be conscious of the information you share if you respond.

All,

Attached is a permit application to install new sewer mains across and along Interstate 5 between milepost 233 and 234. Let me know if you have any questions.

Thanks.

Chris Cerklewski, P.E.
City of Albany - Public Works, Engineering
P.O. Box 490
Albany, OR 97321
(541) 917-7646 Phone
chris.cerklewski@albanyoregon.gov

DISCLAIMER: This email may be considered a public record of the City of Albany and subject to the State of Oregon Retention Schedule. This email also may be subject to public disclosure under the Oregon Public Records Law. This email, including any attachments, is for the sole use of the intended recipient(s) and may contain confidential and privileged information. Any unauthorized review, use, disclosure or distribution is prohibited. If you have received this communication in error, please notify the sender immediately and destroy all copies of the original message.